

Workshop Consumables



Consumables

At Your Convenience

Autogem, the multi award winning consumables provider has been a trusted brand for over 60 years supplying to vehicle manufacturers as well as national, regional & independent businesses.



Scan the QR code to see us in action at our UK based headquarters and learn more about our business.



How to Order



Order Online

www.shop.autogem.co.uk



Call

0208 838 0910 (Option 1)



Email

sales@autogem.co.uk











Online Login Details:

Username..... Password.....

Delivery

Orders placed before 3:00pm will be processed the same day.
Parcel orders will be delivered within 2 working days.



Workshop Tools	4	
Automotive Tools	20	
Tyre Shop	40	
TPMS	54	
Automotive	62	
Assortment Boxes	69	
Chemicals & Adhesives	82	
Cleaning & Safety	96	
EV Tools & Equipment	105	
Commercial Vehicles	108	

Images and Brands are used for reference purposes only. Every effort has been made to ensure all of the information in this catalogue is correct at time of print. We reserve the right to alter any information without prior notice. E. & O.E. Autogem and i-Sensor are registered trademarks of Autogem Invicta Ltd. Copyright Autogem Invicta Ltd 2023. All Rights Reserved.

 **YouTube** @TheAutogem

 **LinkedIn** @Autogem-Invicta-ltd

 **twitter** @Autogem_UK

Workshop Tools

Air Tools.....	5
Inflation Equipment.....	8
Airline Hoses & Fittings.....	9
General Hand Tools.....	11
Lighting & Battery Maintenance.....	18



1/2" Torque Limited Impact Wrench



 **Chicago Pneumatic**

WT617

- 1/2" composite impact wrench with friction ring socket retainer 2 setting positions:
- Torque Limited in forward and Extreme Torque in reverse
- 60/70 ft. lbs. - 90/100 Nm in torque limited position in forward
- 920 ft.lbs - 1,250Nm of maximum torque in reverse
- Aluminium clutch & rear housings
- Thermo-plastic rubber injected in housing
- Resistant to most chemicals used in workshops
- Universal & durable twin hammer mechanism
- Full teasing trigger
- 360° swivel air inlet

1/2" Drive Impact Wrench



 **Chicago Pneumatic**

WT618

- 960 ft.lbs / 1,300 Nm of max torque in reverse position
- One-hand reverse system (Ring system)
- Hard anodized end plates / Hard chromium aluminium cylinder / Twin hammer mechanism
- 4.4 lbs - 2.0 kg thanks to its composite motor housing
- Name laser engraved at the back of the tool
- Curved handle with rubber material
- Resistant to most chemicals used in workshops
- Rubber grip at the back
- Does not slip when it is in operator's hand even if it is dirty or oily
- 6.89 in. / 175 mm in length

1/2" Drive Compact Impact Wrench



 **Chicago Pneumatic**

WT619

- Ultra compact design
- Steel front cover & Aluminium body
- One hand operation forward - reverse by either left or right handed users
- 3 setting positions
- Only 4.4" long
- Jumbo hammer

1/2" Drive Compact Impact Wrench



 **Chicago Pneumatic**

WT626

- Jumbo hammer mechanism
- Steel motor with composite cover
- Direct drive transmission mechanism
- 220 ft.lbs - 300 Nm of maximum torque in reverse
- Over moulded composite and ergonomic handle to fit perfectly in hand
- Full teasing trigger
- Single handed Forward - Reverse operation
- 3 positions in forward and 1 in reverse
- 9.8 in / 240 mm length & 3.46 in. / 88 mm height
- 2.46 lbs. - 1.12 Kg





Workshop Tools

Air Tools



1/2" Drive Heavy Duty Impact Wrench



AL100H

- 1/2" Drive heavy duty impact wrench with 1/4" bsp air inlet
- With protective PVC guard
- 7000rpm free speed
- Maximum torque 230ft lb
- Variable speed trigger control



1/2" Drive Impact Wrench



ALT100

- Pin clutch hammer mechanism
- Lightweight - Only 2kgs
- Reduced vibration
- 540Nm of torque
- 3.6cfm average air consumption

10mm Reversible Air Drill



AL107H

- Polished aluminium housing and planetary gear drive assembly
- Features reversible action making this tool suitable for driving fixings
- Fitted with 10mm Jacobs key-less chuck
- Suitable for general workshop use

10mm Reversible Air Drill



ALT107

- Ideal for drilling, reaming & honing this reversible drill has a side mounted forward / reverse shift & a triple planetary gear system.
- The positive trigger action & powerful air motor making this drill a great all rounder
- 10mm (3/8") key-less chuck
- Rear exhaust through handle



1/2" Drive Air Ratchet



ALT105H

- 1/2" SD air ratchet
- 150 rpm free speed
- 45 ft lb maximum torque
- 1/4" air inlet

3/8" Drive Air Ratchet



ALT105

- 3/8" SD ratchet
- Forward / reverse knob on the ratchet head
- Ball type retainer
- Progressive throttle
- 60Nm of torque
- 4cfm average air consumption



Die Grinder



ALT102

- One-handed straight type die grinder with aluminum body and trigger with safety catch
- Chuck accepts grinding points with 6mm shanks
- Supplied with chuck spanners

Air Tool Accessories



- ❶ 1 - TRT510: Buffing Flap Wheel
- ❶ 2 - TRT998: Golf Ball Buffing Stone
- ❶ 3 - TRT517: Adhesive Removal Tool (Disc)
- ❶ 4 - TRT518: Adhesive Removal Tool (Conical)
- ❶ 5 - WT91: Twisted Knot Wire Brush





Workshop Tools

Inflation Equipment

Tyre Inflators



- ❶ **ALT201:** MK4 Inflator c/w 21" Hose & Single Clip On Connector
- ❶ **AL50:** MK4 Inflator c/w 6ft Hose & Twin Clip On Connector
 - Reduce operating costs with fast inflation and deflation rates
 - Long life with excellent shock resistance
 - Highly versatile, suitable for indoor & outdoor environments, commercial & retail applications
 - Guaranteed accuracy

Metal Blowgun with Safety Nozzle



- ❶ **AL05**
 - Outlet pressure on blowguns should not exceed 28psi
 - It is recommended that an in-line regulator be fitted to your air system
 - Robust / compact design
 - Extensive, easy to fit, additional nozzle range
 - Display packed for convenience

Digital Tyre Inflators

NEW



- ❶ **ALT1823:** DTI Tyre Inflator 0.5m - Euro Clip-on
- ❶ **ALT1822:** DTI Tyre Inflator 1.8m - Euro Clip-on
 - Modern lightweight and shock resistant
 - Auto power off
 - Long battery life with battery level indicator
 - Pressure given in psi, bar or kpa units
 - Individually tested and certified

Connectors



- ❶ **ALT204:** Single Clip-On Connector 4.75mm Open End



- ❶ **ALT206:** Euro Style Connector 8.00mm Open End



- ❶ **ALT207:** Euro Style Connector 6.00mm Open End



15m Rubber Air Hose



AL01

- Made from high specification rubber this air hose has a working pressure of 300psi (21 bar)
- 1/4" female threaded fittings
- Conforms to ISO 5774:1980
- Conforms to BS6066-1981
- Exceeds BS5118

15m Air Hose Reel - Metal Case



AL01REEL2

- 15m retractable air hose reels
- Metal reel casing
- 1/4" female threaded fitting: Inlet
- 1/4" male threaded fitting: Outlet

20m Air Reel Hose 1/4" S-Pin Plastic Casing



AL34

- Easy to use adjustable hose stopper - Reduces non-value-added time
- Auto retract - Easily and smoothly rewinds the hose
- Durable, high impact polypropylene construction
- Built-in cleaning brushes as standard
- Copper tail outlet thread with dust cap
- Steel wall mount 180 degrees swivel bracket
- Robust rubber PVC alloy air hose with a 10mm bore
- Supplied with cleaning brushes and adjustable hose stop. Also features 13-second slow retract option
- Stylish design

6.3m Nylon Coated Hose



AL03

- Made from high specification rubber PVC this air hose has a working pressure of 300psi (21 bar)
- 1/4" male fittings
- Conforms to ISO 5774:1980
- Conforms to BS6066-1981
- Exceeds BS5118





Workshop Tools

Airline Hoses & Fittings



PCL is recognised as the global market leader in the design & manufacture of tyre inflation and compressed air products for industrial, petrol forecourt and automotive markets. This ongoing success has been built on providing superior customer service with the commitment of a loyal and highly skilled workforce.

PCL's "Made in Sheffield" couplings range from the AIRFLOW range for fixed applications and VERTEX for trailing applications, to the common industry interchanges and safety couplings.

- Steel construction
- Corrosive resistant finish
- Free flow air rate at 7 bar (100lbf/in²) of:
35 to 40ft³/min
59.5 to 68m³/hr
991 to 1133 litres/min

1/4" BSP Standard Adaptors

AL18



AL06



AL07



AL12



- **AL18:** 1/4" Female Adaptor (Pack of 1)
- **AL06:** 1/4" Male Adaptor (Pack of 5)
- **AL07:** 1/4" Hose Tail-piece Adaptor (Pack of 3)
- **AL12:** Safety Adaptor Set (3pc)

1/4" BSP Airflow Airline Couplings

AL09



AL14



AL11



AL04



- **AL09:** Female Airflow Coupling (Pack of 2)
- **AL14:** Male Airflow Coupling (Pack of 2)
- **AL11:** Twin Airflow Coupling (Pack of 1)
- **AL04:** Airflow Coupling Set (3pc)

1/4" BSP Vertex Airline Couplings

AL32



AL33



- **AL32:** Female Vertex Coupling (Pack of 2)
- **AL33:** Male Vertex Coupling (Pack of 2)

For 1/2" Fittings
See Page 110





8pc 1/2" Drive Deep Impact Socket Set



- ❶ **WT148** (8pc)
 - 8pc 1/2" drive deep impact socket set
 - Chrome molybdenum
 - Black finish
 - Sizes (mm): 12, 13, 14, 17, 19, 21, 22 & 24

40pc Hex - Star Spline Bit Set



- ❶ **WT385** (40pc)
 - Set includes:
 - Hex bits: 4mm, 5mm, 6mm, 7mm, 8mm, 10mm & 12mm
 - Star bits: T20, T25, T30, T40, T45, T50 & T55
 - Spline bits: 5mm, 6mm, 8mm, 10mm & 12mm
 - All bits in short & long types
 - 3/8"D & 1/2"D adapters

Socket Adaptor Set



- ❶ **WT146** (3pc)
 - High quality alloy steel
 - For use with standard power tools
 - 1/4", 3/8" & 1/2" adaptors

27pc Socket & Bit Set



- ❶ **WT419** (27pc)
 - Set includes
 - Tamper proof bits T8, T10, T15, T20, T25, T27, T30, T40
 - 3/8"D star bits T20, T25, T27, T30, T40
 - 1/2"D star bits T45, T50, T55, T60, T70
 - 3/8"D star sockets E10, E12, E14, E16, E18
 - 1/2"D star sockets E20, E22, E24
 - Complete with tamper proof bit adaptor
 - Presented in metal storage case

Torx Bit Set



- ❶ **WT422** (23pc)
 - S2 silicon steel bits
 - Set includes:
 - Torx® bits - 6 sided:
 - T10, T15, T20, T25, T30 (1/4" Hex)
 - T40, T45, T50, T55, T60 (10mm Hex)
 - Torx Plus® Tamper-proof bits - 5 sided:
 - TP10, TP15, TP20, TP25, TP30 (1/4" Hex)
 - TP40, TP45, TP50, TP55, TP60 (10mm Hex)
 - Chrome molybdenum holder & driver
 - 1/4"D & 3/8"D adaptors





Workshop Tools

General Hand Tools



Security Torx Bit Set



- ❶ **WT346:** 2" Security Torx Bit Set (7pc)
- ❷ **WT347:** 1" Security Torx Bit Set (7pc)
- S2 silicon steel bits
- WT346 includes:
 - T10, T15, T20, T25, T27, T30 & T40
- WT347 includes:
 - T9, T10, T15, T20, T25, T27 & T30

Security Bit Set



- ❶ **WT348** (32pc)
- Alloy steel bits
- Set includes a wide selection of common security bit types & sizes

1/2" Drive Deep Impact



- ❶ **WT280:** 10mm **WT281:** 11mm **WT282:** 12mm
- ❷ **WT283:** 13mm **WT284:** 14mm **WT285:** 15mm
- ❸ **WT286:** 16mm **WT287:** 17mm **WT288:** 18mm
- ❹ **WT289:** 19mm **WT292:** 22mm **WT294:** 24mm
- ❺ **WT295:** 27mm **WT296:** 30mm **WT297:** 32mm
- ❻ **WT471:** 36mm **WT476:** 41mm
- 1/2" drive deep sockets
- 6 point
- Single hex
- Chrome molybdenum
- Impact socket for air tools
- Individual

12pc Engineers Screwdriver Set



- ❶ **WT335** (12pc)
- Professional engineers screwdriver set
- High impact plastic handles
- Heat treated carbon steel blades
- 10 x Through-Tang blades with hex drive for use with spanner or socket

Set includes:

- | | |
|---------------------|---------------------|
| ■ Pozi No.0 x 75mm | Slotted 3.2 x 75mm |
| ■ Pozi No.1 x 75mm | Slotted 5.0 x 75mm |
| ■ Pozi No.2 x 38mm | Slotted 6.0 x 38mm |
| ■ Pozi No.2 x 100mm | Slotted 6.0 x 100mm |
| ■ Pozi No.3 x 150mm | Slotted 8.0 x 150mm |
| ■ Pozi No.4 x 200mm | Slotted 9.5 x 200mm |



To View Our Full Range of Sockets, Go To:
www.shop.autogem.co.uk



Copper & Hide Mallet



EXT06

- Iron headed hammer with one pure copper face and one hide face
- Copper face is used for a safe high impact blow
- Hide face used to give a firm blow that will not mar finished work

Heavy Duty Rubber Mallet - 2.5lb



EXT09

- Strong, black rubber mallet
- 2.5lb
- General purpose
- Gives a gentle but firm blow
- Little rebound

1.8Kg Rubber Dead Blow Hammer



WT608

- Dead blow hammers ideal when the need for knocking off wheels that have seized to hubs arises
- Designed to minimize damage to the struck surface whilst also delivering minimal elastic rebound helping avoid accidental damage to surrounding areas
- Fitted with a fibreglass shaft and soft grip handle for added user comfort

MOT Corrosion Assessment Hammer



WT70

- Combines tapping hammer, blunt scraper & short lever

Claw Hammer - 1.0lb



WT191

- Claw hammer
- 1.0lb
- Fibre glass shaft with rubberised grip

Lump Hammer - 2.5lb



WT17

- Lump hammer
- 2.5lb
- For delivering close heavy blows





Workshop Tools

General Hand Tools



Sledge Hammer - 3.0lb



- WT190
- 3.0lb
- Fibre glass shaft
- Soft grip rubber



Club Hammer - 2.0kg



- WT189
- Lump hammer
- 2.5lb
- For delivering close heavy blows



Hacksaw



- HAK06
- Professional 12" hacksaw with blade
- Strong, light frame for greater comfort & control



Hacksaw Blades



- HAK210: 12" x 24TPI Blade (Pack of 10)
- HAK214: 12" x 24TPI Bi-Metal Blade (Pack of 10)
- High carbon steel & bi-metal hacksaw blades
- Super flexible
- Shatterproof
- 12" x 18TPI & 24TPI



Ball Pein Hammers



- WT56: 4oz
- WT57: 1.0 lb
- WT58: 2.0 lb
- Ball pein hammer
- Engineers metal working hammer

4 Row Wire Brush



- WKC20 (Pack of 5)
- General purpose heavy duty wire brushes
- Ideal for removing rust & debris

Heavy Duty Steel Wire Brush



- WKC21U
- Heavy duty steel wire brush
- Crimped steel wire fill
- Ergonomic plastic handle
- Narrow face
- Ideal for removing rust, paint & debris
- Aids cleaning in hard to reach areas

Utility Knife



- WT64
- 3 position, retractable blade
- Blade storage in handle



10" Utility Snips Straight & Curve



WT79

- Polished high alloy forged blades
- Serrated for extra grip
- Multi purpose snips for cutting vinyl, wire mesh & other household items

9" Offset Snips Straight & Right Curve



WT51

- Hot drop forged chromium steel
- Precision ground
- Cuts up to 18 gauge mild steel
- Designed for outside trimming & clean cuts
- Can be used to cut materials such as gaskets, wire mesh, plastics, linoleum, rubber, canvas and twine

6" Side Cutters



WT10

- 6" (150mm) long
- Spring loaded
- Ergonomic soft grip handles

8" Long Nose Pliers



WT27

- Long nose for better access
- 8" (200mm) long
- Serrated jaws
- Spring loaded
- Ergonomic soft grip handles

7" Combination Pliers



WT09

- 7" (175mm) long
- Serrated jaws
- Spring loaded
- Ergonomic soft grip handles

10" Water Pump Pliers



WT72

- Straight jaw
- 5 groove joint for positive lock
- Moulded handles for extra grip

6" Long Nose Locking Pliers



WT40

- Long nose
- 150mm (6") long
- Spring loaded locking
- For use in automotive precision work

7" Curved Jaw Locking Pliers



WT199

- Locking grip
- Bull nose
- 180mm (7")





Workshop Tools

General Hand Tools



Circlip Pliers Set



- WT193 (4pc)
- 4pc circlip pliers set



Flexible Worm Drive Hose Clip Tool



- HCT01



Professional Combination Spanner Set



- WT424 (16pc)
- 16pc professional combination spanner set
- Drop-forged chrome vanadium steel
- Hardened, tempered & chromed
- Fully polished, mirror finish
- Open end & ring combination
- Long slim, flat panel shaft
- Supplied in hanging pouch
- Pouch can be neatly rolled for storage
- Ideal for automotive work
- Sizes (mm):
- 10, 11, 12, 13, 14, 15, 17, 18, 19, 20, 21, 23, 25, 28, 30 & 32



'O' Clip Pliers



- OCP
- For easy fitment of 'O' clips
- Slip 'O' clip over hose & use the pincers to close the lugs of the clip

Adjustable Wrenches



- WT43: 150mm (6") Adjustable Wrench
- WT44: 200mm (8") Adjustable Wrench
- WT45: 250mm (10") Adjustable Wrench
- Practical tools for mechanics or DIY enthusiasts

Combination Spanners



- WT110: 6mm WT111: 7mm WT112: 8mm
- WT113: 9mm WT114: 10mm WT115: 11mm
- WT116: 12mm WT117: 13mm WT118: 14mm
- WT119: 15mm WT120: 16mm WT121: 17mm
- WT122: 18mm WT123: 19mm WT124: 20mm
- WT125: 21mm WT126: 22mm WT127: 23mm
- WT128: 24mm WT129: 25mm WT130: 26mm
- WT131: 27mm WT134: 36mm
- Combination spanners
- Bi-Hex
- Chrome vanadium
- Satin finish
- 6-36mm size range
- Further sizes available up to 50mm



Screwdriver Bit Sets



- ❶ **WT340:** 50mm Pozi No.2 Bit Set (5pc)
- ❶ **WT344:** Titanium coated 50mm Pozi No.2 Bit Set (10pc)
- Use with power tools & screwdrivers

Mains Tester Screwdrivers



- ❶ **WT337:** Small Mains Tester Screwdriver
- ❶ **WT338:** Mains Tester Screwdriver
- TUV/GS approved
- Pocket clip
- Suitable for 220-250 volts

Kneeling Mat



- ❶ **MAT03AGM**
- Quality 28mm EVA kneeling mat ideal for the busy mechanic
- Oil and water-resistant
- Suitable for use on workshop floor when working on wheels, brakes, tyres and exhausts

Screwdriver Bit Sets



- ❶ **WT341:** 50mm Assorted Pozi Bit Set (5pc)
- ❶ **WT342:** 50mm Assorted Slotted & Pozi Bit Set (5pc)
- Use with power tools & screwdrivers

Stainless Steel 6" Magnetic Tray



- ❶ **WT182**
- 6" round magnetic tray for storing metal objects during work

Telescopic Inspection Mirror



- ❶ **WT180**
- Telescopic inspection mirror
- Extendable to 350mm / 14"

10lb Magnetic Pick Up Tool



- ❶ **WT181**
- Magnetic pick up tool
- Extends from 6.1/2" to 26"
- Picks up 10lb maximum





Workshop Tools

Lighting & Battery Maintenance



Compact Rechargeable Hand Lamp



LAMP22

- Featuring 3W COB super bright light
- Rubber covered magnet
- Supplied with USB cable

3W Cob Inspection Lamp



LAMP06

- Featuring 3W COB super bright light
- Single LED battery indicator
- Rubber covered magnet
- Lithium-ion polymer battery for longer life, charge time 5-6 hours and can operate for up to three hours on a single charge
- Supplied with mains & cigarette lighter charger

3W Cob Lamp + Top Mounted LED



LAMP04

- Featuring 3W COB super bright light
- Additional top mounted torch light
- Single LED battery indicator
- Two 360° swivel hanging hooks for hands-free applications allowing unit to be used horizontally or vertically
- Rubber covered magnet
- Bottom quarter of the lamp rotates 180° allowing the unit to be positioned for ease of use on any ferrous surface
- Lithium-ion polymer battery for longer life, charge time 5-6 hours and can operate for up to three hours on a single charge
- Supplied with mains & cigarette lighter charger

15W Ultra Slim Inspection Lamp



LAMP08

- Featuring 15W COB super bright light
- 360° magnetic swivel base
- Adjustable intensity
- Lithium-ion polymer battery for longer life, charge time 5-6 hours and can operate for up to three hours on a single charge
- Supplied with mains & USB charger



Compact Headlamp With Glass Lens



- ❶ **LAMP07:** Battery Operated
- ❶ **LAMP19:** Rechargeable
 - 3W CREE LED Chip
 - Compact small size
 - Robust ABS/aluminium housing
 - Glass optical lens
 - Adjustable focus
 - Complete with batteries (3xAA)
 - Three modes of operation - high/ low/ strobe
 - Belt pouch and lanyard

120 LED Under Bonnet Lamp



- ❶ **LAMP13**
 - Rechargeable Under Bonnet Lamp
 - 120 LED work lamp (800 lumens)
 - Supplied with 240V Mains & 12V DC chargers
 - 3 way switch on both sides
 - Built in magnets or hook attachments to secure
 - Telescopic mounting brackets fits 1.2m - 1.9m
 - Light source can be rotated 90 degrees for improved visibility

Hand-held Battery Tester



- ❶ **WT496**
 - Tests starter grounding contact & alternator
 - Tests a wide range of batteries including: AGM, VRLA, SMF etc - up to 1700CCA
 - Print & save results to PC via USB link
 - Reports easily customised by the garage
 - Fast, accurate & consistent results
 - Illuminated LED display
 - Multi-lingual - 10 languages, user selection

Start Charger 12/24V 45Amp



- ❶ **WT497**
 - Heavy-duty starter/charger for professional garages, workshops and body shops
 - Caters for all requirements from cars right up to light commercial vehicles
 - Large wheels for easy mobility and features analogue ammeter and switchable charge circuitry for accurate charge control



Automotive Tools

Servicing & Lubrication.....	21
Braking.....	24
Steering & Suspension.....	29
Air con & Cooling.....	30
Exhaust.....	31
Wheel Removal & Fitting.....	32
Locking Wheel Nut Removal.....	35
Lifting Equipment.....	38



Drain Plug Key Set



- ❶ **SUT02** (6pc)
 - Double end chrome vanadium steel
 - Satin finish
 - Suitable for sump plugs on engine, gearbox & back axle
 - Use with 14mm spark plug socket on a ratchet driver

**For Sump Washers
See Page 73**



Oil Filter Chain Wrench



- ❶ **SUT01**
 - Heavy duty chain with tightening nut
 - Operated with 1/2" square drive or 24mm wrench

Oil Filter Cap Wrench Set



- ❶ **WT425** (15pc)
 - 14 wrenches for a variety of vehicles
 - Suitable for canister filters
 - Withstand 85ft lbs torque
 - Includes 3/8" drive adaptor
 - Supplied in a blow mould storage case
- Applications include:
AC, BMW, Daihatsu, Fiat, Ford, Honda, Isuzu, Mazda, Mercedes-Benz, Mitsubishi, Nissan, Porsche, Renault, Subaru, Toyota, Vauxhall/ Opel, Volkswagen and many other vehicles



Oil Filter Strap Wrench



- ❶ **WT16**
 - 1/2" drive oil filter strap wrench



Automotive Tools

Servicing & Lubrication



Manual Vacuum Oil & Fluid Extractor



WT437

- Manual vacuum oil & fluid extractor
- 7.0L capacity
- Constructed from composite materials
- Suitable for the extraction of all types of engine, transmission & lubricating oils from cars, motorcycles, marine engines, stationary engines and industrial machinery
- Supplied with 4 x 1m suction probes
- Uses probes to drain engine oil through the dipstick tube

16L Oil Drain Pan



WT493

- Suitable for both the DIY user and professional mechanic
- Purpose-made for the recovery of oil and antifreeze, the pan helps to keep the workshop floor free from oily residue and aid return of oil to recycling containers with minimum risk of spills or splashes
- Made from high-density polyethylene with UV stabiliser
- Heavy-wall construction stays rigid, even with hot oil
- Excess capacity helps prevent overflow or spillage

Rotary Oil Drum Pump



WT15

- Cast steel body, suitable for oils, antifreeze, degreasers and other non-corrosive fluids
- Supplied with 2" BSP adaptor and is suitable for use on 205L drums
- Delivers approximately 0.3L/revolution

16L Anti-Freeze Drain Pan



WT494

- Suitable for both the DIY user and professional mechanic
- Purpose-made for the recovery of oil and antifreeze, the pan helps to keep the workshop floor free from oily residue and aid return of oil to recycling containers with minimum risk of spills or splashes
- Made from high-density polyethylene with UV stabiliser
- Heavy-wall construction stays rigid, even with hot oil
- Excess capacity helps prevent overflow or spillage



Oil Filter Funnels



SUT03



SUT07

- ❶ **SUT03:** Oil Filler Funnel - 6"
- ❶ **SUT07:** Oil Filler Funnel - 9"
- Professional quality funnel with screw on flexible extension

Oil Measuring Jug



- ❶ **SUT12:** Oil Measuring Jug - 2L
- ❶ **SUT05:** Oil Measuring Jug - 5L
- Calibrated oil measuring jugs
- Screw on detachable spout



Grease Gun



- ❶ **GN17**
- 10,000psi working pressure
- Complete with rigid tube & hydraulic connector

Grease Gun Hose



- ❶ **GN18**
- Flexible Hose Extension - 12"



4 Jaw Hydraulic Coupler



- ❶ **GN13** (Pack of 5)



Metal Oil Can



- ❶ **WKC02**
- Metal oil can
- Includes rigid & flexible spouts

Plastic Oil Can



- ❶ **WKC01**
- 500cc plastic oil can





Automotive Tools

Braking



Pressure Brake Bleeder



❶ BPT42

- Pressure brake bleeding is the only method approved by brake manufacturers
- Full fluid change in approx 15 minutes by a single operator
- No compressed air used
- No possibility of contamination of the fluid
- Includes Euro cap & bleed bottle
- Operates off vehicle's own 12v supply
- 1.5 Bar
- Capacity 1.25L
- Suitable for brake & clutch bleed

Brake Fluid Safety Meter



❶ BPT41

- Boiling point tester: the only test method approved by brake & brake fluid manufacturers
- Operates off vehicle's own 12v supply
- User friendly LCD screen instructions lead operator through the complete testing sequence
- Measures up to 320°C, suitable for use on all grades of brake fluid
- Accurate, reliable & repeatable results
- Test takes only 30 seconds
- Increase service revenue & road safety

Multi Vehicle Cap

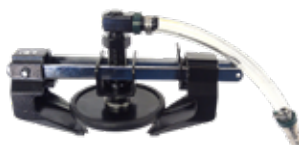

❶ BPT43

- 30-85mm diameter fitment
- Fits screw on & bayonet type reservoirs
- Unique patented gripping design
- Compatible with BPT42

Brake Fluid Tester



❶ WT434

- Identifies the amount of water in brake fluid
- Colour coded LEDs show water level & action required
- Quick & Simple
- Suitable for Dot 3, Dot 4 & Dot 5
- Not Suitable for Silicone Based Dot 5.1

Vacuum Brake & Clutch Bleeder



❶ WT499

- Easy one-person operation
- Simple hand-pump operation to create pressure
- Supplied with European cap adaptor with swivel elbow 42.8mm
- Quick-release coupling, pressure relief valve
- 5 bar pressure gauge
- 3L capacity
- Suitable for brake & clutch bleed



Brake Pad Measuring Tool



WT270

- Ensures brake pad thickness is accurately measured & logged
- Eight pre-set thicknesses to determine status of pads - 2mm to 12mm
- Colour coded to indicate amount of wear:
Green = Good
Amber = Partially Worn
Red = Need Replacing
- Can be used with the wheels on or off the vehicle

18pc Brake Caliper Wind-back Set



WT271

- 18pc brake caliper wind-back set
- Contains both left & right hand threaded rewind tools
- 1 x reaction plate
- 15 x popular adapters

Air Operated LH and RH Windback Tool



BPT49

- Pneumatic tool for brake caliper piston rewind
- Suitable for pin type or 3/8" drive type
- For left & right handed threaded pistons
- Supplied with a 3/8 to 2 pin magnetic adaptor to fit adaptors in 3991
- Full adaptor range available
- Time saving tool

One Handed Brake Pad Spreader



BPT55

- Essential tool for retracting the brake piston to allow insertion of new brake pads
- Suitable for most ATE, Bendix, Delco & Girling callipers
- Chemically blackened steel spreader plates





Automotive Tools

Braking



Digital Brake Disc Measuring Gauge



● BPT58

- Metric & imperial
- Measurement Range: 0mm - 150mm
- Accuracy: +/- 0.15mm
- Presented in sturdy plastic case



Hydraulic Brake Pipe Flaring Kit



● BPT51

- Handles Cupro-Nickel and steel pipes
- High quality SAE and DIN flares
- Use in-situ
- Flares 4.75mm, 5mm and 6mm pipes



Manual Drum Measuring Gauge (Vernier)



● BPT53

- Brake drum wear gauge
- Large size range 160mm-400mm
- Selected steel
- Measures drum wear
- Metric and Imperial

Mini Tube Cutter



● BPT15

- Die-cast cutter body
- Heavy duty HSS hardened cutting wheel
- Smooth screw action for clean cutting performance



Flexible Hose Clamps



❶ BPT44 (3pc)

- For use on flexible hose lines on brakes, fuel systems, heaters & radiators
- Lightweight, non-conductive material
- High visibility colour for easy location
- Single handed use
- Jaws of 1/2" to 3/4" diameter
- Plastic construction reduces risk of shorting electrical systems

Bar Hose Clamps



❶ BPT52

- Clamps any hose simply and effectively
- Chrome plated bars
- Use on brake, fuel and heater hoses
- No sharp edges
- Ensures complete clamp



Brake Pipe Corrosion Tool



❶ BPT48

- For service, maintenance & pre-MOT inspection
- MOT compliant
- Soft grip handle
- Patented product

7mm Hex Key



❶ BPT26

- Multiple uses on many popular vehicles
- Brake seat fittings
- Disc brake release bolts
- Gearbox drain plugs
- Valve adjustment





Double End Brake Spring Washer Tool



❶ BPT45

- Aids installation & removal of T-slot anti-rattle washers in drum brake assembly
- Large viewing cut-away allows correct alignment of nail & washer
- Simple push and twist action
- Time saving tool



Brake Pipe Ratchet Wrench



❶ WT421: Brake Pipe Ratchet Wrench 10mm

❶ WT420: Brake Pipe Ratchet Wrench 11mm

- Open ring ratchet mechanism
- Available in 10mm & 11mm
- Chrome vanadium construction
- Two in one tool saves time and money
- Can be used whenever a standard ratchet ring spanner is used



Handbrake Cable Spring Pliers



❶ BPT47

- Quick and easy removal and installation of hand brake cable
- For compressing the retaining spring
- Knurled grip handles
- Time saving tool
- Suitable for on Audi, BMW, Citroën, Nissan, Peugeot, Renault, Rover, Seat, Volkswagen

Brake Cleaner Spray Can



❶ BC08: 1L Brass Head

For Brake Cleaner
See Page 83





Air Operated CV Boot Gun



DRS01

- Air operated CV boot tool
- Installs CV boots without removing drive shafts from the vehicle or the CV joint from the drive shaft
- Composite body with simple control valve
- Suitable for cars and light commercial vans
- Save on labour time by up to 70%
- Prevent damage to CV joint
- Made in the UK

Rack End Installation Tool



DRS05

- No need to remove track rod end, simply slide tool over and onto the knuckle
- Designed to remove the axle joint/track rod from the steering rack
- 35-45mm diameter
- Can be used with 1/2"D wrench or 27mm spanner



Bearing & Bush Installation Kit



DRS07

- For use on bushes, bearings seals
- 20 sizes of adaptors ranging from 34-72mm
- Double sized adaptors
- 4 threaded bars
- Universal use
- Time saving tool

Slide Hammer Puller Set



DRS10

- Robust 10lb slide hammer
- 5/8 UNF thread
- Supplied in blow moulded carry case
- Use eight ways:
 - Internal/ external three leg puller
 - Internal/ external two leg puller
 - Grip wrench adaptor
 - Lip puller
 - Hub puller
 - Dent puller





Automotive Tools

Steering & Suspension - Air Con & Cooling



Ball Joint Splitter



DRS02

- Drop-forged & heat treated alloy steel
- Suitable for applications with awkward or limited access



Hub Puller Adaptor



DRS11

- Hub puller adaptor
- Complete with 5/8" UNF adaptor for slide hammer DRS10
- PCD (Pin Centre Diameter) from 97mm to 123mm
- For use on 3, 4 and 5 bolt fixing drive flanges



Anti-Freeze Testers



WT432



WT433

- WT432:** Anti-Freeze Tester for Ethylene Glycol
- WT433:** Anti-Freeze Tester for Propylene Glycol
- Designed for Ethylene Glycol or Propylene Glycol antifreeze
- Easy to read indicator
- Floating discs indicate coolant strength
- Tests at hot & cold temperatures
- Reads in °C & °F

Universal Hub Puller



DRS13

- Universal hub puller
- Suitable for four & five stud hubs

Brake Disc Removal Tool Ford Transit



DRS03

- Hub puller adaptor
- Complete with 5/8" UNF adaptor for slide hammer DRS10
- PCD (Pin Centre Diameter) from 97mm to 123mm
- For use on 3, 4 and 5 bolt fixing drive flanges

Mini Digital Thermometer



WT435

- High precision digital thermometer
- Sensor located in tip of stainless steel probe
- Compact & lightweight
- Measures °C & °F
- HOLD function
- Ideal for testing automotive air conditioning output
- 1.5V battery powered (supplied)



Exhaust Pipe Chain Cutter



❶ EXT01

- Professional quality chain cutter
- Eliminates the need to cut pipes with a torch where access is limited

Heavy Duty Exhaust Pipe Chain Cutter



❶ EXT12

- Professional quality chain cutter
- Eliminates the need to cut pipes with a torch where access is limited
- Suitable for cutting thin-wall tubing up to 2.5mm thick

Fitting Tool For Rubber Rings



❶ EXT11

- Enables easy connecting of rubber rings over hooks on silencer boxes

Exhaust Mounting Removal Pliers



❶ EXT15

- Enable easy removal of stubborn exhaust mountings

Exhaust Clamp Spreader



❶ EXT22

- Specialist tool designed to remove & fit PSA exhaust clamps fitted to Citroen, Peugeot & Renault vehicles

7 Piece Lambda Sensor Set



❶ EXT27

- Suitable for Titania and Zirconia oxygen sensors found on most modern vehicles
- Windows and slots enable sockets to be fitted over wiring harness





Automotive Tools

Wheel Removal & Fitting



1/2" Drive Torque Wrench (70-350Nm)



WT380

- 1/2" Sq drive torque wrench
- 70Nm - 350Nm
- Reversible ratchet
- Weight: 1.43kg
- Length: 580mm
- Accuracy set +/- 4%
- Delivered in blow mould case
- Supplied with calibration certificate



1/2" Drive Torque Wrench (40-200Nm)



WT380CP

- Accuracy: 4% according to the EN ISO 6789:2003 specifications
- Long-lasting accuracy up to 25000 cycles
- Durable: Reliability of the mechanism up to 25000 cycles
- Robust: 54 teeth fixed pear head ratchet
- Comfort: Black aluminium handle resistant to common chemicals in workshops
- Compact: To work in restricted areas



600mm 1/2" Drive Breaker Bar



WT383

- **WT384:** Spare Knuckle Joint For WT383
- Ideal for loosening wheel bolts
- Hardened and tempered Chrome Vanadium steel bar with high chrome finish
- Long, slim style handle and spring loaded socket retention
- Fully replaceable knuckle joint



600mm 1/2" Drive Heavy Duty Breaker Bar



WT383H

- Ideal for loosening wheel bolts
- Hardened and tempered Chrome Vanadium steel bar with high chrome finish
- Multi position head and spring loaded socket retention
- Knurled non-slip handle design
- Long, slim style handle and spring loaded socket retention





Total Contact Alloy Wheel Impact Socket Set

WT147H

- Ideal 3pc alloy wheel set
- Heavy duty, colour coded 17, 19 & 21mm sockets
- "Total Contact" technology for superior grip
- Ensures reduced rounding of wheel nuts
- Plastic sleeve to protect the wheel from damage
- 1/2" square drive heavy duty
- Forged chrome molybdenum steel
- Hardened for strength
- Tempered for greater durability
- Anodised for corrosion resistance
- Suitable for use with impact tools
- Use with torque wrench for a perfect fit



SCAN TO LEARN
MORE ABOUT OUR
TYRE TOOLS &
CONSUMABLES



7pc Heavy Duty Alloy Wheel Impact Socket Set



WT470 (7pc)

- 1/2" drive alloy wheel impact socket set
- Chrome molybdenum
- External & internal sleeve avoids damage to wheel & nuts
- Hardened, tempered & anodised for corrosion resistance
- Six point
- Suitable for use with impact tools
- Colour coded
- Sockets available individually
- Sizes (mm): 17, 19, 21, 22, 23, 24 & 27

Mercedes Benz 17mm Wheel Nut Socket



WT436

- 1/2" Drive 17mm WAF
- Manufactured from chrome vanadium
- Thin wall with protective sleeve
- Application:
- C-Class (W204)
- E-Class (W211, W212, W207)





Automotive Tools

Wheel Trolleys



120Kg Trolley



NEW



WT640

- The top is made of 100% recycled excess material from the car industry and recycled parts from damaged cars
- Reduces the emission of 4 - 11 kg CO2 per trolley - depending on the model
- Measures 630 mm/ 24.9 inches in diameter
- For 8 tyres or 4 complete wheels
- Max load is 120 kg/ 270 lbs



250Kg Trolley



NEW



WT642

- The top is made of 100% recycled excess material from the car industry and recycled parts from damaged cars
- Reduces the emission of 4 - 11 kg CO2 per trolley - depending on the model
- Measures 800 mm/ 31.4 inches in diameter
- For 8 tyres or 4 complete wheels
- Max load is 250 kg/ 552 lbs



180Kg Trolley



NEW

WT641

- The top is made of 100% recycled excess material from the car industry and recycled parts from damaged cars
- Reduces the emission of 4 - 11 kg CO2 per trolley - depending on the model
- Measures 700 mm/ 27.6 inches in diameter
- For 8 tyres or 4 complete wheels
- Max load is 180 kg/ 400 lbs

Easy Lift 180Kg Trolley



NEW

WT643

- Wheel Trolley Easy Lift is the most ergonomic variant within our range of Wheel Trolleys
- It is an elevated Wheel Trolley, which, with the help of springs, raises and lowers in relation to load
- Adjusts height in relation to the load
- Designed for 4 wheels and may be used for, amongst others, the mounting/dismounting of wheels
- Supplied with wheel brakes on 2 casters
- Improves ergonomics when handling tyres
- Measures 700 mm/ 27.6 inch
- For 4 complete wheels
- Max load is 180 kg/ 400 lbs
- Available with 2 wheel brakes (optional extra)



Universal Locking Wheel Nut Remover Kit

❶ WT628

- Simple-to-use master kit capable of removing most locking wheel nuts
- Kit includes shroud, which protects the wheel against any damage
- Very effective and a must have workshop tool
- Replacement disposable cutters available separately, see below



C Cutter Replacement Blade

❶ WT629 (Pack of 5)

- Replacement cutter blades for most applications
- To be used in conjunction with WT628



WT630

WT631

WT632

Locking Wheel Nut Removal Blades

❶ WT630: Range Rover

❶ WT631: Jaguar

❶ WT632: Ford

- Specially designed cutters for use on vehicle specific locking wheel nuts
- To be used in conjunction with WT628





Automotive Tools

Locking Wheel Nut Removal



Wheel Stud Thread Restorer Kit



WT423

- For repairing damaged wheel stud threads
- Size range; M12 x 1.25, M12 x 1.5 & M14 x 1.5
- Spare O-ring
- Ensures alignment of existing thread



Wheel Bolt Key Set BMW 88-10 21pc



WT601 (21pc)

- 21 essential wheel nuts lock keys equivalent to BMW OEM 36 1 300. The kit includes the contents of Part No 6168 (OEM 36 1 335)
- Includes 17mm wheel nut drive socket x 1/2"D. Manufactured from SCM440 steel and chrome plated
- Tamper-proof: 13pt to 23pt and Non tamper-proof 7pt to 16pt



4pc Locking Wheel Nut Removal Kit



WT149 (4pc)

- Forged chrome molybdenum steel
- 1/2"Sq drive
- Removes locking wheel nuts when key is not available
- May also be used on fixings too damaged or corroded for standard sockets
- Set includes drift to aid removal of fixing from socket
- Phosphate finish for resistance to corrosion
- Suitable for use with impact wrenches
- Sizes (mm): 17, 19, 21 & 22

Wheel Bolt Key Set Audi 22pc



WT600 (22pc)

- A locking wheel nut key set equivalent to T40073
- Applications: Audi vehicles
- 20 x Locking wheel nut keys - suitable for tyre fitting bays and garages
- Complete with 21mm x 1/2"D locking adaptor
- Includes removal punch



Wheel Bolt Key Set BMW 08-14 10pc



WT602 (10pc)

- Installation and removal - Splined style BMW locking wheel nuts tool kit
- Sizes: 13pt (30), 15pt (31), 16pt (32), 17pt (33), 18pt (34), 19pt (35), 20pt (36), 21pt (37), 22pt (38), 23pt (40)
- Application: Early F type BMW and Mini models Ref: 36 1 335

Wheel Bolt Key Set BMW 14-16 22pc



WT603 (22pc)

- Designed to fit OE style BMW wheel nuts
- Applications: 1 Series F20/F21, 3 Series F30/F31, 4 Series F32/F34/F36, 5 Series F10/F11, 6 Series F12/F13 and 7 Series F01/F02/F04
- Included 20 x keys, 1 x adaptor and 1 x punch
- Equal to OEM 36 2 010



Wheel Bolt Key Set VAG early models 23pc



WT604 (23pc)

- 23 essential wheel nut lock keys: 6pt to 17pt, 0/10pt, 1/11pt, 2/13pt, 3/14pt, 4/15pt, 5/16pt, 6/17pt, 7/19pt, 8/20pt, 9/21pt
- Includes 17mm wheel nut drive socket. Equivalent to OEM T10101 and T40004 combined in one kit
- Manufactured from SCM440 steel and chrome plated

Wheel Bolt Key Set VAG late models 20pc



WT605 (20pc)

- A set of locking wheel nut sockets for the Volkswagen range Application: UP Polo (2010-), Beetle (2012-), Golf (2009-), Jetta (2011-), EOS, Scirocco, Passat (2006-), Sharan, Touran, Tiguan
- Equivalent to OEM T10313





Automotive Tools

Lifting Equipment



2 Ton Ultra Low (77mm) Long Reach Jack



COM2T-77

- Ergonomically designed handle for operator comfort. Rubber coated
- Additional foot pedal pumping feature provides fast saddle raising to the load
- Safety lowering control valve for safe lowering even under maximum load
- Protective cylinder jacket to prevent intrusion of dirt and welding splatter
- Min. height 77 mm
- Max. height 480 mm

3 Ton Jack (LCV & 4WD)



COM3T-C

- Additional foot pedal pumping feature provides fast saddle raising to the load
- Long reach chassis improves access to lifting points deep under vehicles
- Safety lowering control valve for safe lowering even under maximum load
- Pressure relief valve prevents overloading
- Heavy duty fully welded structure in high quality steel
- Ergonomically designed handle for operator comfort. Rubber coated

2 Ton Low Entry Jack



COM2T-C

- Ergonomically designed handle for operator comfort. Rubber coated
- Additional foot pedal pumping feature provides fast saddle raising to the load
- Safety lowering control valve for safe lowering even under maximum load
- Protective cylinder jacket to prevent intrusion of dirt and welding splatter
- Min. height 80 mm.
- Max. height 500 mm

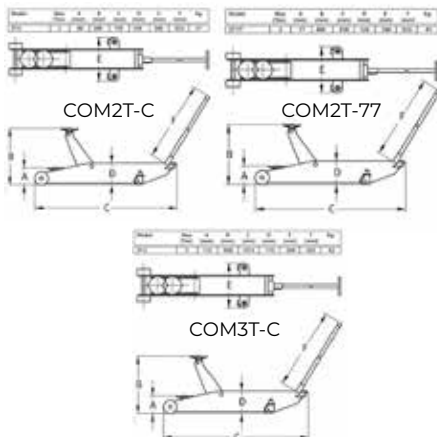

Rubber Pad For Compac Jacks



COM1002LF

- Designed to protect the lifting point
- Suitable for 2 Ton & 3 Ton Jacks



3T Fixed Axle Stands (Pair)



WT365H

- All steel construction to BS standards
- 3 Tonne capacity each axle stand
- Easy to use with a lifting range of 270mm to 360mm

3T Folding Axle Stands (Pair)



WT366H

- Easy to use and adjust axle stands which fold for convenient storage. All steel construction
- 3 Tonne capacity each axle stand
- Easy to use with a lifting range of 300mm to 430mm

600KG Transmission Jack



WT368

- Manufactured to exacting standards, strong construction for durability and suitable for general workshop applications
- Spring loaded dead man's safety release control reduces the risk of inadvertent lowering
- Two way hydraulic unit ensures that the saddle lowers at a controlled speed at all times, even without load
- Extra large castors allow for increased manoeuvrability
- Hydraulic unit larger than the economy models for improved performance and durability

500KG Engine Brace



WT369

- Heavy Duty steel construction with 500kg capacity
- The dual hooks allow the engine or gearbox to be held safely to the desired position to be worked on
- 750mm - 1450mm foot width adjustment with rubber feet to prevent slipping and paint damage
- Supplied with 2 x 930mm support chains

Jacking Pad Set Tesla



WT273

- Made from high quality rubber, providing a sturdy and durable point of contact



Tyre Shop

Wheel Weights & Tools.....	41
Tyre Valves & Accessories.....	43
Tyre Repair Chemicals.....	44
Tyre Repair Patches.....	47
Tyre Repair Tools.....	48
GEMSEAL.....	5



SCAN TO
LEARN MORE
ABOUT OUR
TYRE TOOLS &
CONSUMABLES



Steel Wheel Weights



- ❶ TRW205S: 5g (x100) ❶ TRW210S: 10g (x100)
- ❶ TRW215S: 15g (x100) ❶ TRW220S: 20g (x100)
- ❶ TRW225S: 25g (x100) ❶ TRW230S: 30g (x100)
- ❶ TRW235S: 35g (x50) ❶ TRW240S: 40g (x50)
- ❶ TRW245S: 45g (x50) ❶ TRW250S: 50g (x50)
- ❶ TRW255S: 55g (x50) ❶ TRW260S: 60g (x50)
- Universal steel wheel clip on weight

Assorted Steel Wheel Balance Weights



- ❶ TRW200KIT (60pc)
- Assortment of popular steel wheel weights
- Weights: 5g, 10g, 15g, 20g, 25g, 30g, 35g & 40g

Adhesive Weights



- ❶ TRW600S: Uncoated Adhesive Wheel Weights (Silver) – 5g & 10g
- ❶ TRW600Z: *Premium* Coated Adhesive Wheel Weights (Grey) – 5g & 10g
- Oversized protective strip on adhesive backing to enable easy peel
- Superior strength adhesive tape ensuring the weights stay on the wheel
- High quality, anti-corrosion plastic coating or standard zinc plated weights
- Easy to cut strips
- 6Kg Boxes (100 Strips)

Alloy Wheel Weights



- ❶ TRW305S: 5g (x100) ❶ TRW310S: 10g (x100)
- ❶ TRW315S: 15g (x100) ❶ TRW320S: 20g (x100)
- ❶ TRW325S: 25g (x100) ❶ TRW330S: 30g (x100)
- ❶ TRW335S: 35g (x50) ❶ TRW340S: 40g (x50)
- ❶ TRW345S: 45g (x50) ❶ TRW350S: 50g (x50)
- ❶ TRW355S: 55g (x50) ❶ TRW360S: 60g (x50)
- Universal alloy wheel clip on weight

Assorted Alloy Wheel Balance Weights



- ❶ TRW300KIT (60pc)
- Assortment of popular alloy wheel weights
- Weights: 5g, 10g, 15g, 20g, 25g, 30g, 35g & 40g

Black Adhesive Weights



- ❶ TRW500B: *Premium* Coated Adhesive Wheel Weights (Black) – 5g & 10g
- Oversized protective strip on adhesive backing to enable easy peel
- Superior strength adhesive tape ensuring the weights stay on the wheel
- High quality, anti-corrosion plastic coating
- Easy to cut strips
- Black finish ideal for black coloured alloy wheels
- 3Kg Box (50 Strips)





Wheel Weight Pliers



TRT512

- For the attachment & removal of clip on weights



Residue Removal Tools



NEW

TRT517: Standard Disc Style

TRT518: Premium Conical Style

- Adhesive residue removal tool
- Conical style
- Cleans efficiently & safely
- No damage to rims or finishes
- Can also be used to remove decals
- Max RPM: 4000
- Use with air buffing tools, see page 7



Standard Tyre Lever & Lever Cover (Sleeve)



TRT195: Spoon type 20" tyre lever

TRT195C1: Lever Cover (Sleeve)



Adhesive Weight Remover



TR515

- Plastic weight removal tool
- Prevents damage to alloy wheels

Rim Protector



TRT525

Bead Cheetah



WT609

- The Cheetah (or Bead Booster / Blaster) has turned one of the most frustrating and time-consuming jobs in the tyre shop into one of the quickest and easiest
- Seats the beads of difficult tubeless tyres instantly by directing a rush of air into the gap between the tyre and rim, lifting the bead to give a contact seal which allows the tyre to inflate
- Easy to use on car, truck, bus, agricultural and ATV tyres. Perfect for service vehicle and workshop use
- Save time and money; there is no need for various sizes of bead seating rings
- Cheetah works for all sizes, 20-litre air tank
- Supplied with full CE certification



EPDM Snap In Rubber Valves



Part No.	Application	Rim hole	Length	Pack
TRV412	Motorcycles & Scooters	11.5mm	25mm	25
TRV412L	Motorcycles & Scooters	11.5mm	30+30mm	10
TRV413	Passenger Cars	11.5mm	34mm	100
TRV414	Passenger Cars	11.5mm	40mm	100
TRV418	Passenger Cars	11.5mm	53mm	100
TRV415	SUV	16.0mm	35mm	10

Plastic Valve Caps



- ① **TRV400:** Black (Pack of 100)
- ① **TRV400C:** Green (Nitrogen Fill) (Pack of 100)
- Standard plastic valve cap

TPMS Plastic Valve Caps



- ① **TPK403:** Silver (Pack of 100)
- **TPK403B:** Black (Pack of 100)
- TPMS plastic valve cap
- Includes integrated rubber o-ring for additional sealing against contaminants

Snap In High Pressure Valves

TRV600



TRV601



TRV602



Part No.	Application	Rim hole	Length	Pack
TRV600	Light Trucks	11.5mm	35mm	10
TRV601	Light Trucks	11.5mm	40mm	1
TRV602	Light Trucks	11.5mm	50mm	1

Standard Bore Brass Valve Core - Heat Resistant



- ① **TRV401HR** (Pack of 100)
- Valve core
- Standard bore

Standard Bore Valve Core Nickel Plated (TPMS)



- ① **TPK401N** (Pack of 100)
- Standard bore valve core
- Nickel plated
- Suitable for all standard bore valve types, including TPMS valves





Tyre Shop

Tyre Repair Chemicals



Tyre Markers



- ❶ **TR501:** Yellow Wax Markers (5pc)
- ❶ **TR503:** White Wax Markers (5pc)
- Ideal for marking repair area on damaged tyres
- Available in yellow or white



Liquid Tyre Buffing Solution



- ❶ **TR211:** Buffing Solution (1 x 1L)
- Fast drying buffing aid



Aerosol Tyre Buffing Solution



- ❶ **TR212:** Aerosol Buffer (1 x 400ml)
- Fast drying buffing aid



Dusting Chalk



- ❶ **TR502** (400g)
- Applied after tyre & tube repairs
- Helps prevent tubes from sticking & pinching during repairing or changing

Vulcanizing Solutions



- ❶ **TR201:** Vulcanizing Solution (235ml Clear)
- ❶ **TR202:** Vulcanizing Solution (235ml Blue)
- Fast drying vulcanizing cement
- Chemical or heat vulcanization
- TR202 (blue) contains more rubber solids than TR201 for a stronger bond
- Includes top brush

Leak Seek Concentrate



- ❶ **TRL11** (1L)
- For locating puncture position when using a tyre bath



Tyre Fit Paste / Tyre Lube



- ❶ **TRL105** (1 x 5kg)
 - Formulated to give maximum lubrication
 - Economical to use
 - Water Based

Black Tyre Mounting Paste



- ❶ **TRL110** (1 x 5kg)
 - Does not leave white marks on tyre walls
 - Universal tyre mounting / demounting product
 - Excellent lubrication
 - Reduces risk of tyre / wheel damage when fitting
 - Fast drying product reduces spatter on wheels & bodies
 - Water Based

Earthmover Tyre Mounting Paste



- ❶ **TRL109** (1 x 5kg)
 - Designed especially for large off road vehicles
 - Heavy duty bead lubricant

Blue Tyre Cream (Speed Grease)



- ❶ **TRL107** (1 x 5kg)
 - Ideally suited for truck & van tyres
 - Formulated for ease of application
 - Less viscous than normal tyre paste
 - Oil Based

Tyre Mounting Wax



- ❶ **TRL108** (1 x 5kg)
 - Ideally suited for motorcycles, scooter and car tyres
 - Harder compound than the conventional mounting paste
 - Economical to use
 - Oil Based

Tyre Fit Liquid



- ❶ **TRL115** (1 x 5kg)
 - For fitters that prefer to work with a liquid lubricant
 - Highly concentrated for economical use





Rim Sealer



- ❶ TRL106 (1 x 5kg)
- Suitable for steel or alloy wheels
- Designed to protect against corrosion
- Seals porous alloy wheels
- Oil Based



Tyre Mounting Lubricating Spray 400ml



- ❶ TRL121
- Tyre mounting/demounting lubricant for passenger, car, light utility and motorcycle tyres
- Excellent for run flat & low profile tyres
- Simply just spray around the entire tyre
- Reduces wear and tear on your tyre changing machine

1/2 Moon Tyre Bath



- ❶ TRT994
- 1/2 moon tyre bath
- Heavy duty

Bead Sealer



- ❶ TRL101 (1 x 945ml)
- ❶ TRL101X: Extra thick (1 x 945ml)
- Liquid rubber based product for sealing between tyre bead & rim
- Includes top brush

Angled Wooden Lubricant Paste Brush



- ❶ TRT514A
- Aids easy application of tyre mounting pastes
- Angled head to help apply paste to hard to reach areas

Applicator Brushes



TRT514A

- ❶ TRT514: Plastic Lubricant Paste Brush
- ❶ TRT514A: Professional Wooden Lubricant Paste Brush
- Aids easy application of tyre mounting pastes



Combi Plug Repair Patches

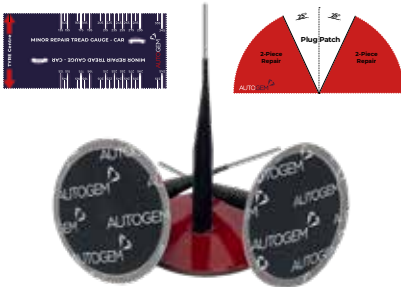

See It



In Action

- ❶ **TR155:** 3mm (50pcs)
- ❷ **TR150B:** 6mm (40pcs)
- ❸ **TR153:** 8mm (48pcs)
- ❹ **TR152:** 10mm (20pcs)
- Complete with pilot stem
- Protective film covering adhesive face
- TR150B packaging includes usable injury position and angle of penetration guides

Radial Repair Patches



- ❶ **TR107:** 55mm x 75mm - Single Ply (20pcs)
- ❷ **TR106:** 60mm x 110mm - Single Ply (20pcs)
- ❸ **TR108:** 80mm x 125mm - 2 Ply (10pcs)
- ❹ **TR124:** 75mm x 175mm - 2 Ply (10pcs)
- ❺ **TR125:** 100mm x 195mm - 3 Ply (10pcs)
- For durable repairs of all radial tyres

Foil Backed Tube Repair Patches

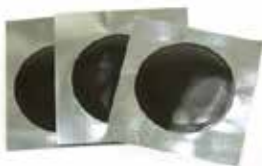

- ❶ **TR100:** 30mm (50pcs)
- ❷ **TR101:** 38mm (40pcs)
- ❸ **TR102:** 45mm (24pcs)
- ❹ **TR103:** 50mm (28pcs)

Tyre Repair Inserts



- ❶ **TR160:** 133mm Tubeless Fibre (40pcs)
- ❷ **TR161:** 100mm Heavy Duty Brown (30pcs)
- ❸ **TR162:** 200mm Heavy Duty Brown (25pcs)
- ❹ **TR163:** 184mm Heavy Duty Black (50pcs)
- Ideal for a temporary injury fill
- Emergency repair only

Universal Square Patches



- ❶ **TR104:** 37mm (100pcs)
- ❷ **TR105:** 48mm (50pcs)
- ❸ **TR116:** 57mm (50pcs)

Cross-ply Patches (Bias Ply)



- ❶ **TR131:** 92mm - 2 Ply (10pcs)
- ❷ **TR132:** 112mm - 2 Ply (10pcs)
- ❸ **TR130:** 172mm - 4 Ply (10pcs)

Poly Backed Tube Repair Patches



- ❶ **TR118:** 35mm (48pcs)
- ❷ **TR119:** 52mm (24pcs)
- ❸ **TR120:** 60mm (10pcs)
- ❹ **TR121:** 77mm (30pcs)





Golf Ball Buffing Stone



TRT998

- Spherical rasp
- For mechanical preparation of the inner liner
- 6mm shaft for use with air buffer



Black Oxide Buffing Stone



TRT1010

- Cylindrical rasp
- For mechanical preparation of the inner liner
- 6mm shaft for use with air buffer



Bench Fit Tyre Spreader



TRT101

- Aids the inspection & repair of car & light commercial tyres
- Bench mountable



Inner Liner Scraper



TRT149

- Aids the preparation of the inner liner prior to buffing
- Use with tyre buffer (TR211 or TR212)

Rotary Wire Brush



WT91: 75mm - M10 x 1.50mm Bore

- 75mm twist knot flat wire wheel
- Stainless steel
- Removes heavy rust, paint & debris
- Fitted with 6mm shank for professional use

Buffing Flap Wheel



TRT510

- Buffing flap wheel
- 80 grit finishing tool
- 6mm shaft for use with air buffer

High Speed Steel Reamer



TRT150: 3mm

TRT513: 6mm

TRT151: 8mm

TRT148: 10mm

- Used in the preparation of a tyre injury
- Removes the damaged steel cord
- Carbide tip



Tyre Probe



❶ TRT110

- Screwdriver style tyre probe

Tyre Probe Angled Tip



❶ TRT110B

- Screwdriver style tyre probe
- Angled tip



6mm Reamer Tool With Pistol Grip



❶ TRT146: 6mm Reamer Tool With Pistol Grip

❶ TRT146R: Replacement Needle For TRT146

- Pistol grip style tyre reamer
- 6mm reamer
- Ergonomic pistol grip handle

6mm Spiral Cement Tool With Pistol Grip



❶ TRT144

- Spiral blade cement tool
- Ergonomic pistol grip handle

3mm Reamer Tool With Screwdriver Grip



❶ TRT145

- Screwdriver style tyre reamer
- 3mm reamer

Skiving Knives



❶ TRT111: Standard Tapered Skiving Knife - Plastic Handle

❶ TRT113: Heavy Duty Tapered Skiving Knife - Wooden Handle

- Tapered skiving knives
- For removing rubber valves, trimming plugs & inserts





Open Eye Needle With 'T' Handle



- ❶ **TRT136:** 3" Open Eye Needle With 'T' Handle
- ❷ **TRT135:** 6" Open Eye Needle With 'T' Handle
- Open eye insert tool
- Ergonomic 'T' shaped handle



Side Load Heavy Duty Needle



- ❶ **TRT137:** 8" Side Load Heavy Duty Needle With Pistol Grip
- 8" side load insert tool
- Ergonomic pistol grip handle



Closed Eye Needle



- ❶ **TRT140:** 4" Closed Eye Needle
- Screwdriver style closed eye insert tool
- Standard 4" & heavy duty 8" needle versions

Chrome 'T' Handle & Allen Key



- ❶ **TRT143:** Chrome 'T' Handle & Allen Key
- ❷ **TRT141:** 6" Open Eye Needle For TRT143
- ❸ **TRT142:** 6" Side Load Needle For TRT143
- Chrome 'T' shaped handle insert tool
- Allen key design allows easy replacement or changing of needles
- Allen key included

Side Load Needle



- ❶ **TRT139:** 3" Side Load Needle
- ❷ **TRT138:** 8" Side Load Heavy Duty Needle
- Screwdriver style side load insert tool

Stitcher



- ❶ **TRT102:** Economy 3mm Stitcher
- ❷ **TRT103:** 38 Degree 3mm Ball Bearing Stitcher
- ❸ **TRT104:** 38 Degree 6mm Ball Bearing Stitcher
- Wooden handled roller patch stitcher



Screwdriver Type Valve Core Tools



- ❶ **TRT687:** Standard Bore Long
- ❶ **TRT688:** Standard Bore Short

Screwdriver Type TPMS Valve Core Tool



- ❶ **TPT04:** Standard Bore TPMS (0.40Nm)
 - Ensures valve cores are correctly torqued
 - Avoids over tightening

TPMS Rubber Valve Mounting Tool



- ❶ **TPT35**
 - Enables correct angle to avoid damaging rubber TPMS sensors when pulling into rims
 - Double sided pivot block
 - Can also be used as an aid to hold valves firmly when attaching rubber valves to sensors

Slide On Valve Mounting Tool



- ❶ **TRT900:** Slide On Valve Mounting Tool (Plastic Head)
- ❶ **TRT900S:** Slide On Valve Mounting Tool (Metal Head)
 - Slide on valve mounting tool

Alloy Wheel Valve Mounting Tool (Plastic)



- ❶ **TRT993**
 - Alloy wheel valve mounting tool
 - Screw on type

Steel Wheel Valve Mounting Tool (Metal)



- ❶ **TRT993S:** Standard Steel Wheel Valve Mounting Tool
- ❶ **TRT993B:** Slightly Bent Steel Wheel Valve Mounting Tool
 - Steel wheel valve mounting tool
 - Screw on type





Digital Tread Depth Gauge



TRT639

- Accurate measurement of tread 1-26mm in 0.01mm increments
- Quick & easy to read digital tread depth gauge
- Metric & imperial calibration



Professional Tread Depth Gauge with Calibration Block



WT472

- Easy to read large display
- Metric & imperial scales
- Reading remains until cleared
- Easy to reset zero calibration
- Suitable for tyre tread depth or brake shoe & pad wear
- Includes calibration block

Tread Depth Gauge



TRT638

- Accurate measurement of tread 1-26mm in 1mm increments

VOSA Approved Tread Depth Gauge



TRT638S

- Accurate measurement of tread 1-26mm in 1mm increments
- Department of Transport accepted for MOT testing
- VOSA approved

Push On Pocket Tyre Pressure Gauge



TPG02

- Twin hold on & pen type pocket pressure gauges



GEMSEAL

OE SPECIFICATION

- ❶ GEMSEAL: 1 x 450ml
- ❷ GEMSEAL-KIT: 1 x 450ml + Compressor

- Approved by the largest automotive manufacturers in the world
- Direct replacement for the OE sealant supplied with many new cars today
- Easily washes out of the tyre with water to allow for a full repair
- 450ml for all wheels from 14" to 20"
- Non toxic
- Non corrosive
- TPMS safe



Free P.O.S. Display

With Initial Cases of 20 Units

Scan
To Watch The Video



As Easy As 1, 2, 3...

Inspect - does the vehicle have a spare?

Check - is the sealant missing, partially used or expired?

Offer - cost-effective replacement sealant to renew the vehicle's emergency puncture solution



TPMS

TPMS Service Kits.....	55
i-Sensor® & Replacement Stems.....	58
TPMS Hand Tools.....	59
TPMS Diagnostic Tools.....	60



SCAN TO LEARN
MORE ABOUT
YOUR TRUSTED
TPMS PROVIDER



Metal Valve - Sensata Alpha



TPK02203

- Compatible With Sensata Type 2
- Jeep & Lancia

Metal Valve - VDO TG1C



TPK04202

- Compatible With VDO Type 4
- BMW, Ford, Honda, JLR, Maserati, Nissan, Volvo, US Models & More

Advanced TPMS Valve Stems First Aid Kit



TPK14

- Over 97% coverage, for all the most common vehicles found on the UK roads
- Includes 15 Most Popular Part References (72 Kits In Total)
- 4 Most Common Rubber Valve Kits (24pcs)
- 10 most Common Metal Valve Kits (44pcs)



TPMS Valve Pulling Tool



TPT35

- Enables correct angle to avoid damaging rubber TPMS sensors when pulling into rims
- Double sided pivot block
- Can also be used as an aid to hold valves firmly when attaching rubber valves to sensors



Rubber Valve - Multi-Fit



TPK03101

- Multi Fit Valve Compatible With Many Sensor Types
- Ford, Vauxhall & Many More
- Laser Etched Batch Coded



Metal Valve - VDO TG1B



TPK05201

- Compatible With VDO Type 5
- Citroen, Fiat, Ford, JLR, Mazda, Peugeot, Volvo, US Brands & More





TPMS

TPMS Service Kits



Metal Valve - VDO MB



TPK06201

- Compatible with VDO Type 6
- Mercedes Benz



Metal Valve - HUF / BERU



TPK07201

- Compatible With HUF Type 7,22, TRW Type 10, Lear Type 11
- Alfa Romeo, Aston Martin, Audi, Bentley, BMW, Ferrari, Fiat, Lamborghini, Maserati, McLaren, Mercedes, Mini, Porsche, Rolls Royce, VW & More
- 43mm Silver Base

Metal Valve - HUF / BERU



TPK07203

- Compatible With HUF Type 7, 22, TRW Type 10, Lear Type 11, Smartire Type 24
- Alfa Romeo, Aston Martin, Audi, Bentley, BMW, Ferrari, Fiat, Lamborghini, Maserati, McLaren, Mercedes, Mini, Porsche, Rolls Royce, VW & More
- 49mm Black Base

Service Kit - Pacific



TPK09001

- Compatible With Pacific Type 9
- Infiniti, Kia, Lexus, Nissan, Toyota & More

Metal Valve - TRW



TPK13201

- Compatible With TRW Type 13A
- Hyundai, Kia

Metal Valve Sensata Delta/Gamma



TPK14201

- Compatible With Sensata Type 14,15
- BMW, Maserati, Mercedes, Vauxhall, Rolls Royce & More



Rubber Valve - VDO TG1D



Key
Shape

TPK16101

- Compatible With VDO Type 16
- Alpine, Jeep, Mitsubishi, Nissan & Renault
- Laser Etched Batch Coded

Metal Valve - Sensata Faraday



Key
Shape



TPK18201

- Compatible With Sensata Type 18,19
- Citroen, Dacia, Ford, Hyundai, Kia, Mercedes, Peugeot, Renault, Subaru, Vauxhall, Volvo & More

Rubber Valve - TRW



Key
Shape

TPK20101

- Compatible With TRW Type 20
- Dodge, Jeep
- Laser Etched Batch Coded

Rubber Valve - Pacific



Key
Shape

Clip Included



TPK21101

- Compatible With Pacific Type 21
- Mercedes, Nissan & Renault
- Laser Etched Batch Coded

Metal Valve - Sysgration



TPK30201

- Compatible With Sysgration BLE Type 30
- Tesla



TECHNICAL WORKSHOP
GUIDE WITH **EVERY** TPMS
STARTER KIT





TPMS

i-Sensor® & Replacement Stems



Clamp in i-Sensor® 433MHZ



1 TPS01

- Programmable Sensor for most UK & European Vehicles



Tesla 2.4GHz Bluetooth Sensor



NEW

1 TPS04

- Replacement for OE Sysgration Sensor
- Fits Tesla (2020 onwards)



i-Sensor® Metal Valve - Black



1 TPK01B

- Replacement stem for clamp-in i-Sensor®
- Black
- Includes fitting screw
- For TPS01 & TPS04

Snap in i-Sensor® 433MHZ



1 TPS03

- Programmable Sensor for most UK & European Vehicles

i-Sensor® Metal Valve - Silver



1 TPK01

- Replacement stem for clamp-in i-Sensor®
- Silver
- Includes fitting screw
- For TPS01 & TPS04

i-Sensor® Rubber Valve



1 TPK03

- Replacement stem for snap-in i-Sensor®
- Includes fitting screw
- For TPS03



TPMS Hand Tool Kit

TPT14

- Contains:
 - TPMS Torque Wrench
 - 1/4" Drive 11mm & 12mm Deep Sockets
 - TPMS Grommet Tool
 - Pre-Torqued TPMS Valve Core Tool
 - 5 x Torx Bits (T6 / T10 / T15 / T20 / T20 Long) & 1/4" Hex Adaptor



TPMS Valve Pulling Tool



TPT35

- Rubber Valve Pulling Tool
- Allows Easy Fitting & Removal Of TPMS Rubber Valves
- Rubber Block Aids Setting Of Tool



Pre-Torqued TPMS Valve Core Tool



TPT04

- Screwdriver type valve core tool
- Suitable for standard bore cores
- 0.25Nm

TPMS Grommet Tool



TPT05A

- Aids the fitting & removal of rubber sealing grommets



www.autogem.co.uk/tpms-assistant

Your 24/7, 365 TPMS support facility, available to all i-sensor® users.

Login to benefit from all of the available functions.

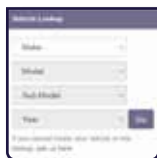

Make, Model, Year Lookup



OE Number Part Search



OE Sensor Type View



Valve Stem Options & Data



Vehicle Relearn Procedures

Online ID Locator



Scan To



Access



TPMS

TPMS Diagnostic Tools



	Basic	Advanced	Advanced+
TPT15 i-Sensor® tool	✓	✓	✓
TPT14 12pc hand tool kit	✓	✓	✓
TPT35 TPMS Valve Puller		✓	✓
TPS01 Clamp-in blank	5pcs	5pcs	5pcs
TPS03 Snap-in blank	5pcs	5pcs	5pcs
TPK14 Valve stem kit		✓	✓
TPT15OBD OBD Attachment			✓
Software updates	First year free	First year free	First year free
Training	e-learning	e-learning	e-learning
Support	onboarding programme, workshop guide, online & telephone support	onboarding programme, workshop guide, online & telephone support	onboarding programme, workshop guide, online & telephone support
	ISOKIT1	ISOKIT2	ISOKIT2.1

i-Sensor® Programming Tool

● TPT15

Features:

- **Reduce expensive downtime** in your workshop and waiting times for your customers
- **Wireless, Contactless Scan** - Check tyre pressures without physically touching the valve giving accurate diagnosis of TPMS sensors
- **Instant availability**; Simply keep a small number of i-Sensor® blanks in stock and create sensors as you need them
- **Duplicate Sensors** - Copy the ID's of faulty sensors quickly to help extinguish those TPMS warning lamps
- **Missing Sensor?** - Create a completely new & unique sensor in as little as 12 seconds
- **Covers over 99%** of existing OE TPMS sensors

- 1 year of complementary software updates; available periodically with all new software developments
- Comprehensive user guides; documentation & marketing support
- 1 year warranty against manufacturer fault
- Mains charger & usb cable
- Windows based software for the application of updates



OBD Attachment For i-Sensor® Programming Tool

● TPT15OBD

- Adds OBDII read & write functionality to the existing i-Sensor® platform
- Allows ECU relearns in circumstances that require it - check vehicle coverage
- Regular updates via USB within existing i-Sensor® update software



	Basic	Advanced
TPT16 i-Sensor® Pro tool	✓	✓
TPT14 12pc hand tool kit	✓	✓
TPT35 TPMS Valve Puller		✓
TPS01 Clamp-in blank	✓ 5pcs	✓ 5pcs
TPS03 Snap-in blank	✓ 5pcs	✓ 5pcs
TPK14 Valve stem kit		✓
TPK03101 Universal valve		✓ 50pcs
Software updates	✓ Free for Life	✓ Free for Life
Training	✓ e-learning	✓ e-learning
Support documents	onboarding programme, workshop guide, online & telephone support	onboarding programme, workshop guide, online & telephone support
	ISPKIT1	ISPKIT2



ARE YOU READY
TO GO **PRO**?

SCAN NOW TO
SEE IT IN ACTION

i-Sensor® PRO Programming Tool

1 TPT16

i-Sensor® pro is our next generation TPMS tool. It takes all the functionality of our i-Sensor® original tool when it comes to diagnosing and programming sensors and then takes it to the next level. The added functionality this future proofed chassis provides allows us to deliver additional solutions, all-ergonomically packaged for the palm of your hand.

Key Highlights:

- **Software Enhancements** - With a large colour screen, faster processor & upgraded interface your TPMS work flow is streamlined with icon driven navigation & built in shortcuts to the essential functions
- **Free Wi-Fi updates** - Simply enter your network SSID & password and enjoy free Wi-Fi updates
- **OBDII Included** - Both a regular cable as well as a Bluetooth OBDII dongle in the box
- **Protect Yourself** - The integrated, auto-focus camera with illuminator light allows you to take up to 8 images per vehicle. The camera also has built in license plate recognition, barcode & QR code scanning capability
- **On-board support** - The large on-board memory gives enough room to provide some of our legendary tech support, on-board. These include relearn procedures, sensor ID locations, OE number locations & even OBDII Port locations
- **Integrated Tread Depth Gauge** - The integrated tread depth gauge is useful for those businesses that operate a "wheel off" policy when measuring tread depth. Measure, save & report against each wheel position via the enhanced-ID to PC software
- **ID to PC upgraded** - The i-Sensor® pro tool allows you to capture and present more data than ever before in a detailed & customisable report

Automotive

Wiper Blades.....	63
Bulbs (12V).....	64
Merchandising Stands.....	66
Cable Ties.....	67
Number Plate Fittings.....	68



Michelin Wiper Blade Starter Pack

1 MSWSTAND

- 50 most popular wiper blades (14"-28")
 - 96% coverage of the vehicle car parc
 - Wall mounted display rack
 - Printed application catalogue
 - Easy to fit, premium quality wipers that are also easy to sell
 - Professional, strong & resealable packaging
 - "Smart-Flex", patented suspension technology
 - Manufactured to strict ISO standards
 - All relevant clips included with each blade
 - One of the world's most recognised brands
 - Fabulous Installer & customer testimonials
 - Training & support provided
- Top-ups of each size available in packs of 5

Part No.	Inches	mm	Qty In Kit
MSW14	14"	350	1
MSW15	15"	375	2
MSW16	16"	400	4
MSW17	17"	425	2
MSW18	18"	450	4
MSW19	19"	475	4
MSW20	20"	500	4
MSW21	21"	530	4
MSW22	22"	550	6
MSW24	24"	600	9
MSW26	26"	650	7
MSW28	28"	700	3
MSW30	30"	750	0



Mercedes Direct Fit Wiper Blades

NEW

The MICHELIN Radius Beam range of wiper blades offer a direct fit replacement for specific Mercedes-Benz A Class, B Class, C Class, E Class, S Class, GLA & GLC models

- Direct Fit Replacement for specific Mercedes-Benz vehicles
- Original Equipment Quality Performance
- TI-TECH COATING™ for severe weather conditions
- Spoiler with 3D air control system
- Easy to Fit with full instructions
- Six part numbers covers most models from 2016

Part No.	Inches	mm
ML22318	18"	450
ML22319	19"	480
ML22322	22"	550
ML22324	24"	600
ML22326	26"	650
ML22328	28"	700



Huge Savings vs Mercedes OE



Automotive

Bulbs (12V)



Bulb Stand

Headlight Bulbs

ECE Ref.	BS Ref.	Part No.	Qty
H1	448	NE448	10
H3	453	NE453	10
H4	472	NE472	5
H7	499	NE499	7

Auxiliary Bulbs

ECE Ref.	BS Ref.	Part No.	Qty
R5W	207	NE207S	10
T4W	233	NE233S	10
C5W	239	NE239S	10
R10W	245	NE245S	10
-	286	NE286S	10
P21/5W	380	NE380S	10
P21W	382	NE382S	10
W5W	501	NE501S	10
WY5W	501A	NE501AS	10
PY21W	581	NE581S	10



NEOLUX
GERMAN TECHNOLOGY

❶ NE510087 (132 pc)

- Ideal way to stock and store bulbs
- Stand contains the most popular headlight and auxiliary bulbs
- Easy to set up and easy to replenish
- Can be positioned on a counter top or it can be wall mounted
- Easy to replenish with single boxed bulbs



Headlamp Bulbs

Halogen Headlight Lamp 448 (H1)



❶ NE448: H1 12V 55W P14.5S

Halogen Headlight Lamp 453 (H3)



❶ NE453: H3 12V 55W PK22S

Halogen Headlight Lamp 472 (H4)



❶ NE472: H4 12V 60/55W P43T-38

Halogen Headlight Lamp 499/477 (H7)



❶ NE499: H7 12V 55W PX26D





Side / Tail / Fog Number Plate Lamp - 207

- ❶ **NE207:** R5W G18 12V
5W BA15S (Pack of 10)



3rd Brake / Number Plate Lamp - 239

- ❶ **NE239:** C5W T11X35 12V
5W SV8.5 (Pack of 10)



Instrument Panel Lamp - 286

- ❶ **NE286:** W1.2WT5 12V 1.2W
W2X4.6D (Pack of 10)



Brake / Tail Lamp - 380

- ❶ **NE380:** P21/5W S25 12V
21/5W BAY15D (Pack of 10)



Side / Number Plate Lamp - 501

- ❶ **NE501:** W5W T10 12V 5W
W2.1X9.5D (Pack of 10)



Brake / Rear Fog / Tail Lamp - 566

- ❶ **NE566:** P21/4W S25 12V
21/4W BAZ15D (Pack of 10)



Side / Number Plate Lamp 233

- ❶ **NE233:** T4W T8.5 12V
4W BA9 (Pack of 10)



Tail / Number Plate Lamp - 245

- ❶ **NE245:** R10W G18 12V
10W BA15S (Pack of 10)



BA15S Amber Bulb - 343

- ❶ **NE343:** 12V 21W
(Pack of 10)



Indicator / Rear Fog Reverse / 3rd Brake - 382

- ❶ **NE382:** P21W S25 12V
21W BA15S (Pack of 10)



Rear Indicator / Side Repeater - 501A

- ❶ **NE501A:** WY5W T10 12V 5W
W2.1X9.5D ORANGE
(Pack of 10)



Indicator Lamp - 581

- ❶ **NE581:** PY21W S25 12V 21W
BAU15S ORANGE
(Pack of 10)





Automotive

Merchandising Stands



CLEARANCE

Hose Clip Rack with 10 Popular Sizes

AND

3 popular sizes

- Top up packs available
- Contains:
 - HC101: Hose Clip 000 : 9.5-12mm
 - HC102: Hose Clip MOO : 11-16mm
 - HC103: Hose Clip OO : 13-20mm
 - HC104: Hose Clip O : 16-22mm
 - HC105: Hose Clip OX : 18-25mm
 - HC106: Hose Clip 1A : 22-30mm
 - HC107: Hose Clip 1 : 25-35mm
 - HC108: Hose Clip 1X : 27-40mm
 - HC110: Hose Clip 2A : 35-50mm
 - HC111: Hose Clip 2 : 40-55mm



CLEARANCE

Battery Stand with Batteries (130 Mixed)

- **BATSTAND** (Pack size: 130)
 - Supplied with 130 batteries
 - Top up packs available
 - Contains:

■ CR2032 x 40	■ CR2025 x 20	■ CR2016 x 10
■ CR1620 x 10	■ CR1220 x 20	■ CR1220 x 10
■ CR1616 x 10	■ 23A x 10	■ AG3 (392) x 10
■ AG3 (394) x 10		



Exhaust Clamp Stand

- **ECD01**
 - Counter, floor or wall mountable display stand
 - Complete with 10 popular clamps sizes
 - 100 clamps in total



Cable Tie Trade Pack



CTPACK (700pc)

- Assortment of popular cable ties
- Black & Silver
- 100mm x 2.5mm Black (200pcs)
- 160mm x 4.8mm Black (200pcs)
- 200mm x 4.8mm Black (100pcs)
- 300mm x 4.8mm Black (100pcs)
- 300mm x 4.8mm Silver (100pcs)

- Black
- Standard type

Part No.	Pack	Length	Width	Max Dia.	Strength
CT06B-1	100	100mm	2.5mm	22mm	8.0kg
CT07B-1	100	160mm	4.8mm	38mm	22.0kg
CT03B	100	200mm	4.8mm	50mm	22.0kg
CT16B	100	300mm	4.8mm	80mm	22.0kg
CT11B	100	370mm	4.8mm	102mm	22.0kg
CT10BQ	100	370mm	7.6mm	102mm	54.4kg
CT13B	100	710mm	9.0mm	207mm	79.4kg



- Natural
- Standard type



- Silver
- Standard type
- Suitable for wheel trims

Part No.	Pack	Length	Width	Max Dia.	Strength
CT11N	100	370mm	4.8mm	102mm	22.0kg

Part No.	Pack	Length	Width	Max Dia.	Strength
CT501	100	300mm	4.8mm	80mm	22.0kg
CT500	100	370mm	4.8mm	102mm	22.0kg





Automotive

Number Plate Fittings



#	Description	Part No.	Qty
1	Black Nylon Screws & Black Nylon Nuts	NP01	100 Sets
2	Yellow Nylon Screws & Black Nylon Nuts	NP02	100 Sets
3	White Nylon Screws & Black Nylon Nuts	NP03	100 Sets
4	Black Caps, Self Tapping Screws & Washers	NP06	100 Sets
5	Yellow Caps, Self Tapping Screws & Washers	NP04	100 Sets
6	White Caps, Self Tapping Screws & Washers	NP05	100 Sets
7	Blue Caps, Self Tapping Screws & Washers	NP07	100 Sets
8	Black Fixed Head 3/4" Self Tapping Screw	NP09	100 Sets
9	Yellow Fixed Head 3/4" Self Tapping Screw	NP08	100 Sets
10	White Fixed Head 3/4" Self Tapping Screw	NP10	100 Sets



Number Plate Fixings

- 1 ATM076 (80pc)
- BLACK: Hinged Caps
- YELLOW: Hinged Caps
- WHITE: Hinged Caps
- Blue: Hinged Caps - Self Tapping Screws
No. 8 x 3/4" Pan Head

Assortment Boxes

Fasteners.....	70
Washers.....	71
Hardware.....	74
Braking.....	76
Electrical.....	78
First Aid.....	80
Bodyshop.....	81



Assortment Boxes

Fasteners

Fasteners - M6



1 ATM042 (295pc)

SET SCREWS:

- M6 x 16 HT
- M6 x 20 HT
- M6 x 25 HT
- M6 x 40 HT
- M6 x 50 HT
- NUTS: M6 DIN 934-8 Nuts

Fasteners - M10



1 ATM044 (88pc)

SET SCREWS:

- M10 x 25 HT
- M10 x 30 HT
- M10 x 40 HT
- M10 x 50 HT
- NUTS: M10 DIN934-8

Metric Plain Steel Nuts (Zinc Plated)



1 ATM011 (370pc)

- M6
- M8
- M10
- M12

Fasteners - M8



1 ATM043 (154pc)

SET SCREWS:

- M8 x 16 HT
- M8 x 25 HT
- M8 x 40 HT
- M8 x 50 HT
- M8 x 60 HT
- NUTS: M8 DIN 934-8

Set Screws Size M6 - M12



1 ATM045 (150pc)

- M6 x 25
- M6 x 40
- M8 x 25
- M8 x 40
- M10 x 25
- M10 x 40
- M12 x 40

Metric Nyloc Steel Nuts (Zinc Plated)



1 ATM012 (220pc)

- M5
- M6
- M8
- M10
- M12
- M14
- M16



Metric Flat Washers Form A



1 ATM013 (800pc)

- M5 ■ M6 ■ M8 ■ M10
- M12 ■ M16

Metric Flat Washers Form C



1 ATM014 (800pc)

- M5 ■ M6 ■ M8 ■ M10
- M12 ■ M14 ■ M16 ■ M20



Imperial Flat Washers Table 3



1 ATM015 (800pc)

- 3/16" ■ 1/4" ■ 5/16" ■ 3/8"
- 7/16" ■ 1/2"

Flat Washers Imperial Table 4



1 ATM016 (800pc)

- 3/16" ■ 1/4" ■ Size: 5/16"
- 3/8" ■ 7/16" ■ 1/2"



Imperial Repair Washers



1 ATM019 (230pc)

- 3/16 x 1" ■ 3/16 x 1.1/2" ■ 1/4 x 1"
- 1/4 x 1.1/2" ■ 5/16 x 1" ■ 5/16 x 1.1/2"
- 3/8 x 1.1/2" ■ 3/8 x 2"

Metric Spring Washers



1 ATM017 (800pc)

- M5 ■ M6 ■ M8 ■ M10
- M12 ■ M16





Assortment Boxes

Washers



Imperial Spring Washers



1 ATM018 (800pc)

- 3/16" ■ 1/4" ■ 5/16" ■ 3/8"
- 7/16" ■ 1/2"



Copper Compression Washers

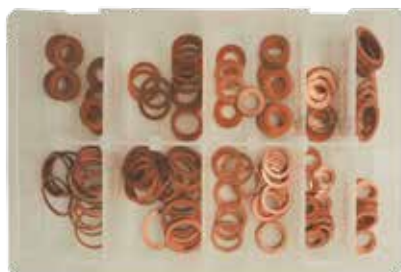

1 ATM023 (250pc)

- 6 x 10 x 1.5mm ■ 8 x 12 x 1.5mm
- 10 x 14 x 1.5mm ■ 12 x 18 x 2.0mm
- 14 x 20 x 2.0mm ■ 16 x 22 x 2.0mm
- 18 x 24 x 2.0mm ■ 20 x 26 x 2.0mm
- 22 x 27 x 2.0mm ■ 26 x 32 x 2.5mm



Bonded Seals Dowty Washers - Metric



1 ATM025 (90pc)

- M10 ■ M14 ■ M16 ■ M18
- M20 ■ M22 ■ M24

Copper Washers Imperial



1 ATM021 (225pc)

- 0.265 x .375" x 20g ■ 0.265 x .473" x 20g
- 0.265 x .500" x 20g ■ 0.323 x .437" x 20g
- 0.323 x .500" x 20g ■ 1/8" BSP x 18g
- 1/8" BSP x 20g ■ 1/4" BSP x 18g
- 1/4" BSP x 20g ■ 3/8" BSP x 20g
- 1/2" BSP x 18g ■ 1/2" BSP x 16g
- 5/8" BSP x 16g ■ 3/4" BSP x 16g
- 7/8" BSP x 16g ■ 1" BSP x 16g

Fibre Washers



1 ATM024 (610pc)

- 13/64" x 3/8" x 1/16" ■ 1/4" x 3/8" x 1/16"
- 3/8" x 5/8" x 1/16" ■ 13/32 x 5/8"
- 29/64" x 11/16" x 1/16" ■ 1/2" x 3/4" x 1/16"
- 5/8 x 7/8" ■ 49/64 x 15/16"

Bonded Seals / Dowty Washers - Imperial

1 ATM026

- (100pc)
- 1/8" BSP
- 1/4" BSP
- 3/8" BSP
- 1/2" BSP
- 5/8" BSP
- 3/4" BSP
- 1" BSP





Diesel Injector Washers



1 ATM022 (360pc)

- 6 x 10 x 1.0mm
- 8 x 11.5 x 1.0mm
- 10 x 14 x 1.0mm
- 12 x 18 x 1.5mm
- 16 x 20 x 1.5mm
- 6 x 12 x 1.0mm
- 10 x 13.5 x 1.0mm
- 12 x 16 x 1.5mm
- 14 x 18 x 1.5mm
- 17 x 21 x 1.5mm

Sump Plug Washers - Mixed



1 ATM020 (250pc)

- 14.5 x 22.0 x 2.0mm Nylon
- 12.25 x 24.0 x 1.5mm Bonded Seal
- 16.0 x 22.0 x 2.0mm Compression
- 18.0 x 24.0 x 2.0mm Compression
- 12.0 x 15.5 x 1.5mm Aluminium
- 14.0 x 22.0 x 2.0mm Aluminium
- 14.0 x 19.0 x 2.5mm Copper
- 14.0 x 20.0 x 1.5mm Copper
- 16.3 x 25.4 x 1.6mm Copper
- 19.0 x 26.0 x 2.0mm Copper



Sump Plug Washers British



1 ATM054 (230pc)

- 17.0mm x 12.0mm Collapsible Copper - Morris
- 19.0mm x 13.5mm Copper - Rover
- 19.5mm x 14.0mm Copper - GM / VW
- 20.0mm x 13.0mm Nylon - Ford OHV
- 21.5mm x 14.5mm Nylon - Ford OHC
- 24.0mm x 16.0mm Dowty Seal - Ford Diesel
- 24.0mm x 16.5mm Copper - Rover
- 25.0mm x 16.0mm Copper - Austin / Rover
- 26.0mm x 20.0mm Collapsible Copper - Talbot
- 28.0mm x 19.0mm Collapsible Copper - Rover
- 1/2" BSP x 13/16" Dowty Seal

Sump Plug Washers European



1 ATM055 (210pc)

- 15.0mm x 12.5mm Copper - BMW
- 19.5mm x 14.0mm Copper - GM / VW
- 19.5mm x 14.5mm Collapsible Copper - VW
- 20.0mm x 14.5mm Copper - SAAB
- 21.0mm x 14.5mm Copper - Citroen / Peugeot
- 22.0mm x 14.5mm Copper - Peugeot
- 22.0mm x 16.0mm Collapsible Copper - Citroen / Renault
- 22.0mm x 16.5mm Dished Aluminium - Skoda
- 22.5mm x 16.0mm Copper - Citroen
- 24.0mm x 15.5mm Copper - SAAB
- 24.0mm x 17.5mm Dowty Seal - Citroen / Peugeot / Renault
- 27.0mm x 14.5mm Copper - SAAB
- 27.0mm x 22.5mm Aluminium - BMW
- 28.0mm x 21.0mm Dowty Seal - Peugeot
- 30.5mm x 26.5mm Copper - VW VR6
- 30.5mm x 27.0mm Copper - Audi / VW





Assortment Boxes

Washers & Hardware



O-Rings - Metric (3mm - 45mm)



AT39 (400pc)

- 3mm x 2mm
- 5mm x 2mm
- 7mm x 2mm
- 10mm x 2mm
- 11mm x 2.5mm
- 14mm x 2.5mm
- 17mm x 2.5mm
- 19mm x 3mm
- 22mm x 3mm
- 25mm x 3mm
- 28mm x 3mm
- 32mm x 3mm
- 35mm x 3mm
- 38mm x 3mm
- 44mm x 4mm
- 4mm x 2mm
- 6mm x 2mm
- 8mm x 2mm
- 10mm x 2.5mm
- 12mm x 2.5mm
- 16mm x 2.5mm
- 19mm x 2.5mm
- 20mm x 3mm
- 24mm x 3mm
- 27mm x 3mm
- 30mm x 3mm
- 33mm x 3mm
- 36mm x 3mm
- 38mm x 4mm
- 45mm x 4mm



O-Rings - Imperial (1/8" - 1.3/4")



AT38 (375pc)

- 1/8" x 1/16"
- 7/32" x 1/16"
- 3/8" x 1/16"
- 1/2" x 3/32"
- 11/16" x 3/32"
- 13/16" x 1/8"
- 1" x 1/8"
- 1.3/16" x 1/8"
- 1.3/8" x 1/8"
- 1.1/2" x 3/16"
- 5/32" x 1/16"
- 1/4" x 1/16"
- 3/8" x 3/32"
- 9/16" x 3/32"
- 3/4" x 3/32"
- 7/8" x 1/8"
- 1.1/16" x 1/8"
- 1.1/4" x 1/8"
- 1.7/16" x 1/8"
- 1.5/8" x 3/16"
- 3/16" x 1/16"
- 5/16" x 1/16"
- 7/16" x 3/32"
- 5/8" x 3/32"
- 3/4" x 1/8"
- 15/16" x 1/8"
- 1.1/8" x 1/8"
- 1.5/16" x 1/8"
- 1.1/2" x 1/8"
- 1.3/4" x 3/16"

Self Tapping Screws Pozi Pan Head No.4-10



ATM046 (700pc)

- 4 x 1/2"
- 8 x 3/4"
- 10 x 3/4"
- 6 x 1/2"
- 8 x 1"
- 10 x 1"
- 6 x 3/4"
- 8 x 1.1/2"
- 8 x 1/2"
- 10 x 1/2"

Self Tapping Screws Pozi Pan Head - No.8-12



ATM047 (330pc)

- 8 x 1.1/2"
- 10 x 1.1/2"
- 12 x 3/4"
- 12 x 1"
- 12 x 1.1/2"
- 10 x 1/2"
- 10 x 3/4"
- 10 x 1"



Self Tapping Screws Pozi Counter Sunk



1 ATM049 (615pc)

- 6 x 1/2" ■ 6 x 3/4" ■ 6 x 1" ■ 8 x 1/2"
- 8 x 3/4" ■ 8 x 1" ■ 10 x 1/2" ■ 10 x 3/4"
- 10 x 1"

Number Plate Fixings



1 ATM076 (80pc)

- BLACK: Hinged Caps
- YELLOW: Hinged Caps
- WHITE: Hinged Caps
- Blue: Hinged Caps - Self Tapping Screws No. 8 x 3/4" Pan Head

Split Cotter Pins Small Sizes



1 ATM027 (1000pc)

- 1/16" x 1" ■ 5/64" x 1" ■ 3/32" x 1.1/2"
- 7/64" x 1.1/2" ■ 1/8" x 1.1/2" ■ 9/64" x 1.1/2"
- 5/32" x 1.5/8"

Self Tapping Screws Pozi Black Flanged



1 ATM048 (700pc)

- 6 x 1/2" ■ 6 x 3/4" ■ 8 x 1/2" ■ 8 x 3/4"
- 10 x 1/2" ■ 10 x 3/4" ■ 8 x 1"

Normal & Large Flange Rivets



1 ATM059 (800pc)

NORMAL:

- 3.2mm x 8.0mm ■ 4.0mm x 10.0mm
- 4.8mm x 14.0mm
- LARGE FLANGE:
- 3.2mm x 10.0mm ■ 4.0mm x 10.0mm
- 4.0mm x 14.0mm ■ 4.8mm x 14.0mm
- 4.8mm x 18.0mm

Split Cotter Pins Large Sizes



1 ATM028 (220pc)

- 1/8" x 1.1/2" ■ 1/8" x 2.1/4" ■ 9/64" x 1.1/2"
- 5/32" x 1.5/8" ■ 3/16" x 2" ■ 3/16" x 3"
- 1/4" x 3" ■ 5/16" x 3"





Assortment Boxes

Hardware & Braking



Spring Roll Pins - Imperial



1 ATM030 (385pc)

- 3/32" x 1" ■ 1/8" x 1 1/2" ■ 5/32" x 3/4"
- 5/32" x 2" ■ 3/16" x 1" ■ 3/16" x 2"
- 1/4" x 1" ■ 1/4" x 2" ■ 5/16" x 1"
- 5/16" x 2"

R-Clips



1 ATM071 (205pc)

- 2.5mm Diameter x 40mm
- 3.0mm Diameter x 54mm
- 4.0mm Diameter x 75mm
- 5.0mm Diameter x 107mm
- 6.0mm Diameter x 117mm

E-Retainer Clips



1 ATM041 (800pc)

- RA1.5-DLE 1.5MM ■ RA2.3-DLE 2.3MM
- RA3.2-DLE 3.2MM ■ RA4-DLE 4MM
- RA5-DLE 5MM ■ RA6-DLE 6MM
- RA8-DLE 8MM ■ RA10-DLE 10M
- RA12-DLE 12M ■ RA15-DLE 15M

Spring Roll Pins - Metric

1 ATM029

(300pc)

- 2.5 x 24mm
- 2.5 x 40mm
- 3.0 x 40mm
- 4.0 x 40mm
- 5.0 x 40mm
- 6.0 x 40mm
- 8.0 x 24mm
- 8.0 x 55mm



Circlips - Internal & External



1 ATM040 (280pc)

INTERNAL:

- J12-DLP 12mm ■ J13-DLP 13mm
- J14-E 14mm ■ J16-E 16mm
- J18-E 18mm ■ J22-E 2mm
- J24-DLP 24mm ■ J25-DLP 25mm

EXTERNAL:

- A12-DLE 12mm ■ A13-DLE 13mm
- A14-DLE 14mm ■ A16-DLE 16mm
- A18-DLP 18mm ■ A22-DLP 22mm
- A24-DLP 24mm ■ A25-DLP 25mm

Brake Bleed Screws



1 ATM034 (60pc)

- 1/4" UNF x 28TPI x 28mm
- 3/8" UNF x 24TPI x 31mm
- M6 x 1mm x 26mm
- M7 x 1mm x 30.5mm
- M8 x 1.25mm x 26.5mm
- M10 x 1mm x 36.5mm





Brake Pipe Nuts



1 ATM033 (135pc)

- 3/8" x 24TPI Long Male Brake Tube Nut
- 3/8" x 24TPI Female Brake Nut
- M10 x 1.0mm Short Male Brake Tube Nut
- M10 x 1.0mm Female Brake Nut
- M10 x 1.0mm Long Male Brake Nut
- M10 x 1.0mm F/T Male Brake Nut

Grease Nipples - Metric



1 ATM066 (150pc)

STRAIGHT:

- | | |
|---------------|----------------|
| ■ M6 x 1.00mm | ■ M8 x 1.00mm |
| ■ M8 x 1.25mm | ■ M10 x 1.00mm |
- 45° ANGLED:
- | | |
|---------------|----------------|
| ■ M6 x 1.00mm | ■ M8 x 1.00mm |
| ■ M8 x 1.25mm | ■ M10 x 1.00mm |
- 90° ANGLED:
- | | |
|---------------|----------------|
| ■ M6 x 1.00mm | ■ M8 x 1.00mm |
| ■ M8 x 1.25mm | ■ M10 x 1.00mm |



Grease Nipples - Imperial



1 ATM065 (125pc)

STRAIGHT:

- | | |
|-----------------|-----------------|
| ■ 1/8" BSP Gas. | ■ 1/4" BSP |
| ■ 1/4" UNF | ■ 1/4" UNF Long |
- 45° ANGLED:
- | | |
|-----------------|------------|
| ■ 1/8" BSP Gas. | ■ 1/4" BSP |
| ■ 1/4" UNF | |
- 90° ANGLED:
- | | |
|-----------------|------------|
| ■ 1/8" BSP Gas. | ■ 1/4" BSP |
| ■ 1/4" UNF | |
- BUTTON HEAD:
- 1/8" BSP Gas.

Blanking & Wiring Grommets



1 ATM035 (240pc)

BLANKING GROMMET:

- | | |
|----------|----------|
| ■ 8.0mm | ■ 9.5mm |
| ■ 12.5mm | ■ 16.3mm |
| ■ 19.0mm | ■ 25.4mm |
- CABLE GROMMET
- | | |
|----------|----------|
| ■ 4.75mm | ■ 6.4mm |
| ■ 8.0mm | ■ 9.5mm |
| ■ 11.0mm | ■ 12.5mm |





Assortment Boxes

Electrical



Insulated Terminals - Red



ATM001 (260pc)

- FEMALE SPADE:
 - 2.8mm
 - 4.8mm
 - 6.3mm
 - 6.3mm Fully Insulated
- FEMALE RECEPTACLE: 4.0mm
- MALE PIGGY-BACK: 6.3mm
- MALE BLADE: 6.3mm
- MALE BULLET: 4.0mm
- BUTT CONNECTORS: Standard
- RING TERMINALS:
 - 3.7mm (4BA)
 - 5.3mm (2BA)
 - 6.4mm (0BA)
 - 8.4mm (5/16")



Insulated Terminals - Blue



ATM002 (280pc)

- FEMALE SPADE:
 - 4.8mm
 - 6.3mm
 - 6.3mm Fully Insulated
- FEMALE RECEPTACLE: 5.0mm
- MALE PIGGY-BACK: 6.3mm
- MALE BLADE: 6.3mm
- MALE BULLET: 5.0mm
- BUTT CONNECTORS: Standard
- RING TERMINALS:
 - 3.7mm (4BA)
 - 5.3mm (2BA)
 - 6.4mm (0BA)
 - 8.4mm (5/16")
 - 10.5mm (3/8")
 - 13.0mm (1/2")

Insulated Terminals - Yellow



ATM003 (110pc)

- FEMALE SPADE:
 - 6.3mm
 - 6.3mm Fully Insulated
 - 9.5mm
 - 9.5mm Fully Insulated
- MALE BLADE: 6.3mm
- BUTT CONNECTORS: Standard
- RING TERMINALS:
 - 5.3mm (2BA)
 - 6.4mm (0BA)
 - 8.4mm (5/16")
 - 10.5mm (3/8")
 - 13.0mm (1/2")

Ring & Fork Terminals - Mixed



ATM005 (200pc)

- FORK TERMINALS:
 - 3.7mm (4BA) Red
 - 3.7mm (4BA) Blue
- RING TERMINALS:
 - 3.2mm (6BA) Red
 - 5.3mm (2BA) Red
 - 3.2mm (6BA) Blue
 - 5.3mm (2BA) Blue
 - 8.4mm (5/16") Blue
 - 6.4mm (0BA) Yellow
- 5.3mm (2BA) Red
- 5.3mm (2BA) Blue
- 3.7mm (4BA) Red
- 8.4mm (5/16") Red
- 3.7mm (4BA) Blue
- 6.4mm (0BA) Blue
- 5.3mm (2BA) Yellow
- 10.5mm (3/8") Yellow



Push On Terminals - Mixed



1 ATM004 (200pc)

FEMALE SPADE:

- 2.8mm Red
- 4.8mm Blue
- 6.3mm Blue
- 6.3mm Fully Insulated Yellow
- 9.5mm Yellow
- 4.8mm Red
- 6.3mm Red
- 6.3mm Fully Insulated Blue

FEMALE RECEPTACLE:

- 4.0mm Red
- 5.0mm Blue

MALE BLADE:

- 6.3mm Blue

MALE BULLET:

- 4.0mm Red
- 5.0mm Blue

MALE PIGGY-BACK:

- 6.3mm Blue

BUTT CONNECTOR:

- Red
- Blue

Heat Shrink Terminals - Mixed



1 ATM006 (120pc)

RED:

- 4.0mm Ring
- 4.0mm Fork
- 6.0mm Fork
- 6.3mm Male Spade
- 5.0mm Ring
- 5.0mm Fork
- 6.3mm Female Spade
- Butt Connector

BLUE:

- 4.0mm Ring
- 6.0mm Ring
- 4.0mm Fork
- 6.3mm Female Spade
- 6.3mm Male Blade
- Butt Connector
- 5.0mm Ring
- 8.0mm Ring
- 5.0mm Fork

YELLOW:

- 4.0mm Ring
- 6.0mm Ring
- 10.0mm Ring
- 5.0mm Fork
- 6.3mm Female Spade
- 6.3mm Male Blade
- Butt Connector
- 5.0mm Ring
- 8.0mm Ring
- 4.0mm Fork
- 6.0mm Fork



Heat Shrink Tubing - 50mm



1 ATM062 (124pc)

- 3.2mm Red
- 3.2mm Blue
- 4.8mm Red
- 4.8mm Blue
- 6.4mm Red
- 6.4mm Blue
- 12.7mm Red
- 12.7mm Blue
- 3.2mm Yellow
- 3.2mm Black
- 4.8mm Yellow
- 4.8mm Black
- 6.4mm Yellow
- 6.4mm Black
- 12.7mm Yellow
- 12.7mm Black

Glass & Ceramic Fuses



1 ATM010 (480pc)

- Ceramic Fuse 5 Amp
- Ceramic Fuse 8 Amp
- Ceramic Fuse 16 Amp
- Ceramic Fuse 25 Amp
- Glass Fuse 2 Amp
- Glass Fuse 10 Amp
- Glass Fuse 25 Amp
- Glass Fuse 5 Amp
- Glass Fuse 15 Amp
- Glass Fuse 50 Amp





Assortment Boxes

Electrical & First Aid



Mini Blade Fuses



1 ATM008 (100pc)

- 2 Amp ■ 3 Amp ■ 4 Amp ■ 5 Amp
- 7.5 Amp ■ 10 Amp ■ 15 Amp ■ 20 Amp
- 25 Amp ■ 30 Amp



Plasters & Wipes



1 AT100 (120pc)

- PLASTERS
- Fingertip:
 - 60mm x 20mm ■ 75mm x 50mm
 - 75mm x 25mm
- ANTISEPTIC WIPES:
 - 185mm x 100mm



Waterproof Dressings



1 AT78 (150pc)

- PLASTERS
- Fingertip
 - 40mm x 40mm ■ 60mm x 20mm
 - 75mm x 20mm ■ 75mm x 25mm
 - 75mm x 50mm



Standard Blade Fuses



1 ATM007 (80pc)

- 2 Amp ■ 3 Amp ■ 4 Amp ■ 5 Amp
- 7.5 Amp ■ 10 Amp ■ 15 Amp ■ 20 Amp
- 25 Amp ■ 30 Amp

Medicated Dressings

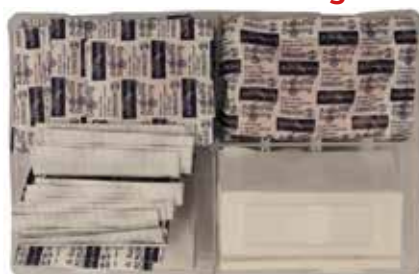

1 AT33 (150pc)

- PLASTERS
- Fingertip:
 - 40mm x 40mm ■ 60mm x 20mm
 - 75mm x 20mm ■ 75mm x 25mm
 - 75mm x 50mm

For First Aid Kits
See Page 104





Popular Drive (Push-Pin) Rivet Assortment



- ① **ATM125** (350pc)
- Push in type clips for:
Volvo, Ford, Mercedes, Peugeot, GM, VW,
Chrysler, Audi, and VAG

Plastic Locking Nut Assortment



- ① **ATM126** (350pc)
- Nut clips, Round nut clips, Screw grommets,
Screw nuts, Headlight nuts, and Connecting
clips for:
Mitsubishi, Toyota, Nissan, Mazda, Ford, VW,
GM, Mercedes, Renault, and Fiat

Plastic Rivets Assortment



- ① **ATM133** (235pc)
- Plastic rivets for:
Ford, Chrysler, VW, GM, and BMW

Assorted Fir Tree Fixings General Use



- ① **ATM134** (340pc)
- Fittings for Battery cable shield, Bonnet
insulation, Bumper shield, Cowl grille, Door
trim, Interior trim for:
Ford, Chrysler, VW, GM, Mazda, Nissan,
BMW, Opel, and Universal

Screw Rivet Trim Fixing Assortment



- ① **ATM135** (240pc)
- Screw in type clips for:
Mazda, Chrysler, Nissan, Honda, Ford, GM,
Mercedes, Audi / VW, and BMW

Trim Clips



- ① **TBF58**: Nissan trim clip (X50)
- ① **TBF59**: VW/ Ford heat shield washer (X50)



Chemicals & Adhesives

Braking.....	83
Aerosols.....	84
Additives.....	88
Lubricants.....	90
Bonding & Sealing.....	91
Tapes.....	95

Brake Cleaner Spray Can



- BC08: 1L Brass Head

DOT4 Brake Fluid



- BF02 (1 x 4.55L)
 - High performance synthetic brake & clutch fluid
 - Exceeds FMVSS 116 Dot 3 & SAEJ 1703 specifications
 - Min boiling point - 230°C

Ceramic Brake Grease



- SQE05 (1 x 200ml)
 - Suitable for all types of brakes pads
 - Resistant to moisture, corrosion and contaminants
 - Outperforms copper based grease
 - Will not affect ABS sensors

Brake & Clutch Cleaner



- BC200 (12 x 500ml)
 - BC500P (1 x 5L)
 - Specialised blend of powerful cleaning solvents
 - High auto-ignition point
 - Evaporates completely, leaving no residue
 - Frees seized brakes
- Instantly removes oil, grease, brake fluid and other contaminants from brake drums, discs, linings, pads and cylinders

Squeal Ease Copper Grease



- SQE02 (1 x 400g)
 - Prevents disc squeal
 - Anti-seize compound
 - Effective up to 2000°F
 - Protects against corrosion, oxidation & rust
 - Eases assembly & dismantling of brake linkages, battery posts, terminals, exhaust manifold studs, clutch splined shafts & cylinder head studs





Penetrating Oil



PDS10 (12 x 400ml)

- Penetrates & Lubricates
- Defends metals from corrosion
- Starts wet engines



Penetrating Oil With Graphite



PG212 (1 x 500ml)

- Rapidly penetrates rusted, seized and corroded bolts, nuts, studs, pins, hinges, locks, linkages & tools
- Formulated to be used in engineering, construction, transport & marine applications
- Not to be sprayed directly on to rubber or painted surfaces

White Grease With PTFE



PG201 (1 x 500ml)

- Contains high viscosity lubricants & load bearing additives to guarantee continual long term effect
- Seals metal parts, providing protection against wear, moisture & rust
- Provides long lasting protection
- Resists heat & salt



Clear Spray Grease



PG220 (1 x 500ml)

- Formulated to give good penetration & improved retention
- Can be used as a general purpose lubricant
- Can be used on metal parts where corrosion & wear protection is required
- Can also be used for the protection of chains, wire ropes & cables

Lithium Grease



PG206 (1 x 500ml)

- Contains high viscosity lubricants & load bearing additives to guarantee continual & long term effect
- Completely seals metal parts, providing protection against wear, moisture, rust & corrosion
- Will not wash off & stays effective up to 180°C

Silicone Spray



PG208 (1 x 500ml)

- Pure non-staining spray that reduces friction on all working surfaces
- Polishes to a glossy film
- Anti-static properties repel dust from all surfaces
- Acts as an effective lubricant from -40°C to 260°C
- Suitable for vehicle interiors, door hinges, plastic, rubber, metal, vinyl, painted surfaces, seals, window fittings & wood

Copper Anti-Seize Spray



PG223 (1 x 400ml)

- Can be used for Industrial, Construction & Automotive applications
- High copper content gives excellent lubrication at high temperatures up to 1200°C
- Eliminates pitting, rusting, threading distortion, galling & seizure
- Ideal for stay bolts & tubes, boiler fittings, compressor heads, pulleys, sprockets, cables, drilling equipment, fittings & fasteners, propeller shafts, pipe fittings, universal joints, heat & pressure gaskets & fuel injector nozzles

Aluminium Anti-Seize Spray



PG222 (1 x 400ml)

- Special formulation to give protection against seizure in extreme service conditions
- Saves threads & parts from galling, distortion & breakage
- Protects against rust & corrosion even in the presence of salt & water
- Prevents bimetallic corrosion
- Does not harden, melt or wash off
- Seals under extreme pressure
- Withstands temperatures up to 800°C
- Can be used on nuts, bolts, flanges, gaskets, pumps & on industrial, construction, agricultural & automotive equipment





Contact Cleaner



PG213 (1 x 500ml)

- Non-residual, quick drying electrical equipment cleaner
- Safely dissolves oil & grease from most surfaces
- Especially suited for electric motors, generators, starters & control panels



EGR Valve Cleaner



PG252 (1 x 500ml)

- Suitable for petrol & diesel engines
- Removes soot & carbon deposits
- Improves fuel economy



Battery Protector



PG204 (1 x 500ml)

- Specially formulated to protect battery terminals from moisture & corrosion
- Provides a rapid cleaning action to remove corrosion, grease & acid
- Acts as an indicator for identifying battery acid leaks
- Suits all vehicle batteries

Turbocharger Cleaner



PG253 (1 x 500ml)

- Fast & efficient turbocharger cleaning
- Removes soot & carbon deposits
- Improves power & consumption of the motor
- Improves fuel economy
- Suitable for variable vane turbos
- Suitable for petrol & diesel engines

Chain Spray



PG202 (1 x 500ml)

- Highly effective penetrating lubricant for chains, wire ropes & open gears
- Reduces wear & prevents the build up of dirt & abrasive grits
- Special anti-fling formula
- Resistant to salt & fresh water wash off

Spray Adhesive



PG210 (1 x 500ml)

- Recommended for light & medium duty carpets, carpet tiles, under-felt, cardboard, paper, plastic, felt, synthetic leather & textiles
- Ideal for vehicle interiors
- Fast acting
- Strong bonding



Gas Leak Detector



PG227 (1 x 400ml)

- Compressed air propellant
- Micro-porous foam shows leaks at any location
- Detects minute leaks
- Suitable for vehicle classes - 3, 4, 5, & 7
- Suitable for gas leak detection on LPG vehicles

Air Con Sanitizer (Air Con Bomb)



PG225 (1 x 400ml)

- Long lasting Air Con bomb leaves the car clean & fresh
- Disinfects vehicle interior
- Removes bacteria & musty odours

See It



In Action





AdBlue® is a clear, liquid solution which consists of deionised water & automotive urea (32,5%) that is injected into the exhaust gasses of a diesel powered engine to reduce the emission of nitrogen oxides (NOx) in combination with SCR (Selective Catalytic Reduction) technology.

The vehicle ECU (Electronic Control Unit) monitors the injection rate of the AdBlue® to the SCR at a typical rate of 2-6% of diesel consumption volume.

Many high volume vehicle manufacturers of cars, 4x4's, buses & trucks now utilise SCR systems & AdBlue® so the replenishment of AdBlue® is becoming more & more common within the automotive industry.

The solution is non-toxic & safe to handle, though must be stored & transported carefully. The product should be stored in a cool, dry & well ventilated area out of direct sunlight. It is important that AdBlue® & the associated equipment is kept protected against any type of contamination.

Description	Part No.	Pack
AdBlue® 5L Bottle	ADB1005	1 x 5L
AdBlue® 10L Can with Filler Spout	ADB1010	1 x 10L
AdBlue® 200L Drum	ADB1200	1 x 200L
Hand Pump for ABD1200	ADBPUMP	1



**Ask About Our
Pallet Deals**





Engine Flush

- ❶ **PG417A** (1 x 250ml)
 - Use prior to an oil change
 - Removes all harmful deposits from the crankcase
 - Free sticking valves
 - Improve compression
 - Prolong the life of the new oil
 - Harmless to rubber seals & breather hoses
 - Restores optimum engine performance
 - Suitable for all petrol & diesel engines



Petrol Treatments

- ❶ **PG411A** (1 x 250ml)
 - Assists in restoring optimum performance
 - Cures flat spots and surging
 - Improves fuel economy
 - Reduces exhaust emissions
 - Removes moisture from the fuel system
 - Formulated to clean and lubricate the entire fuel system, including:
 - Fuel injectors
 - Inlet valves
 - Top piston rings
 - Exhaust valves
 - Lambda sensors & catalytic converters



Diesel Treatments

- ❶ **PG413A** (1 x 250ml)
 - Assists in restoring injectors spray pattern
 - Improves combustion
 - Reduces exhaust emission and carbon deposits
 - Extends injector life
 - Improves fuel economy
 - Prevents surging and stalling
 - Suitable for diesel passenger cars and light commercial vehicles
 - Designed to clean the entire fuel system from the tank through to the injectors





Lithium EP2 Grease



- ❶ GN27: 1 x 300g Cartridge
- ❶ GN28: 1 x 3kg Tin
- Premium quality lithium grease

Cartridge / Caulking Gun

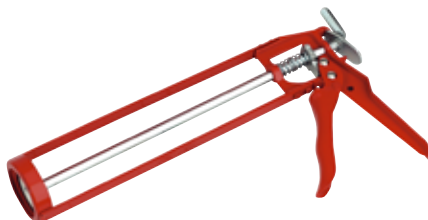

- ❶ PG16
- Skeleton type caulking gun
- Suitable for 310ml cartridges up to 220mm length



Air Tool Oil



- ❶ PG230 (1 x 1L)
- Keeps air tools lubricated
- Low air retention
- Good thermal stability
- Contains anti-corrosion additives
- ISO 32 Viscosity grade oil
- ISO 6743/4, Type : HM
- Vickers :1-286-S

Compressor Oil



- ❶ PG231 (1 x 1L)
- Formulated to keep internal compressor workings lubricated
- Excellent anti wear properties
- Good thermal stability
- Good resistance to oxidation
- Always consult compressor manufacturers specification for lubrication before use
- ISO 32 Viscosity grade oil
- Din 51524 Part 2 (HLP)



GemFill

AN IDEAL, RAPID REPAIR SOLUTION FOR CRACKS AND SMALL CUTS IN THE TYRE TREAD



NEW

TRL114

- Rubber filler adhesive for cosmetic repairs
- Ideal for Commercial, Earthmover, OTR and any other heavy duty tyres
- Quick, easy & cost effective repair
- Can also be used for other structural repairs to automotive trims & fittings
- Applied via the specially designed mixing nozzles (TRL114N) and applicator gun (TRL114G)
- Cures in **2 minutes**



Dispensing Gun

Nozzles for Tyre Fill



TRL114G

- General purpose applicator for use with 50ml twin cartridges
- Provides a ready mixed adhesive
- Consistent flow
- Use with TRL114

TRL114N

- High quality mixing nozzles for use with 50ml twin cartridges
- Ensures a precise 1:1 mix ratio
- Easy to install
- Pack of 10
- Use with TRL114



Chemicals & Adhesives

Bonding & Sealing



Gemlok Industrial Superglue



PG300 (1 x 20g)

- Cyanoacrylate adhesive for close fitting surfaces
- High Strength
- Ultra fast cure
- No mixing required



Gemlok Nutlock



PG302 (1 x 50ml)

- Designed for medium strength locking where components need to be dismantled as part of a regular maintenance schedule
- Eliminates the need for locking nuts
- Prevents nuts and bolts loosening due to vibration
- Seals against corrosion
- Can be undone using hand tools



Gemlok Industrial Superglue



PG301 (5 x 5g)

- Cyanoacrylate adhesive for close fitting surfaces
- High Strength
- Ultra fast cure
- No mixing required

Gemlok Anaerobic Retainer



PG303 (1 x 50ml)

- Designed for high strength retention of sleeves, bushes, pulleys, gears and other slip or press fit parts
- Eliminates the need for mechanical locking methods
- Cures in **15 minutes** giving maximum security to engineered components requiring retention



Silicone Sealant Instant Gasket



- ❶ **PG14** (1 x 310ml)
- ❶ **PG14T** (5 x 310ml)
- Superior quality clear silicone sealant
- Bonds metal, glass, rubber, plastic and many other materials
- Remains flexible when cured
- Resists all lubricating, transmission and cooling fluids
- Withstands high temperatures
- Not resistant to petrol
- Not to be over painted after application

Exhaust Jointing Paste (Cartridge)



- ❶ **GTP07** (5 x 500g)
- Withstands extreme temperatures
- Provides carbon monoxide proof joints from manifold to tailpipe
- Facilitates assembly of exhaust components by lubricating joints during assembly
- Must not be used in any joint in front of a catalytic converter
- Asbestos free

Adhesive Sealant



NEW

- ❶ **ADH218** (1 x 310ml)
- Fast curing polyurethane adhesive sealant For automotive & industrial applications
- Flexible when cured
- Metal Bonding
- Overpaintable
- Low odour
- Black

Cartridge / Caulking Gun



- ❶ **PG16**
- Skeleton type caulking gun
- Suitable for 310ml cartridges up to 220mm length





Chemicals & Adhesives

Bonding & Sealing



Gemlok Clear Rapid Epoxy



PG306 (1 x 28ml)

- Industrial strength clear rapid epoxy adhesive
- Bonds automotive trims in place, vehicle badges, emblems, tool handles, furniture parts and repairs broken porcelain, china and jewelry
- Resistant to oil, gas, alcohol, water and detergents
- Cures in under **5 minutes**



Gemlok Plastic Repair Stick



PG311 (1 x 55g)

- Designed to repair all common plastics
- Repairs cracks in fibre glass and GRP mouldings, bumpers, spoilers and plastic trims
- Can be used to rebuild cracks in plastic tanks, boat hulls and sail boards, even in the presence of water
- Hardens in **15 minutes**
- Can be sanded and feathered back in 1 hour
- Provides an excellent emergency repair

Gemlok Gasket Maker



PG307 (1 x 50ml)

- Designed to make a gasket shim between close fitting machined surfaces
- Commonly used on modern engines where gasket surfaces are extremely well engineered
- Seepage of the material outside the bond area will not cure and would be washed away safely within the oil or water system

Gemlok Metal Repair Stick



PG312 (1 x 55g)

- Designed to repair all common metals, alloys, ferrous and non-ferrous materials
- Mixes easily in the hand and will repair cracks in gear boxes, sumps and other castings
- Repairs stripped threads and can be used to rebuild broken metal parts
- Hardens in **5 minutes**
- Can be drilled, tapped and sanded in 1 hour

Masking Tape



- ❶ ADH102: 24mm x 50m (Pack of 5)
- ❷ ADH103: 48mm x 50m (Pack of 4)
- ❸ ADH104: 36mm x 50m (Pack of 4)
- General purpose masking tape for automotive use
- Sticks firmly to most surfaces
- Easy & clean removal

Insulation Tape



- ❶ ADH111: 19mm x 20m PVC Tape Black (Pack of 10)



Trim Tape



- ❶ ADH121: 12mm x 5m (Pack of 3)
- ❷ ADH122: 19mm x 5m (Pack of 2)
- Adhesive double sided trim tape

Hazard Marking Tape



- ❶ ADH142: 38mm x 50m (Pack of 2)
- High visibility hazard marking tape



Silver Duct Tape



- ❶ ADH150: 50mm x 50m (Pack of 2)
- General purpose, high adhesive duct / gaffer
- Easy to tear
- Waterproof

Black Duct Tape



- ❶ ADH150: 50mm x 50m (Pack of 2)
- General purpose, high adhesive duct / gaffer
- Easy to tear
- Waterproof



Cleaning & Safety

Gloves.....	97
Interior Protection.....	98
Disposable Paper & Wipes.....	99
Hand Care.....	101
Cleaning.....	102
First Aid Kits.....	104



Blue Nitrile



- ❶ **HY270M:** Medium (Pack of 100)
- ❶ **HY270L:** Large (Pack of 100)
- ❶ **HY270XL:** X-Large (Pack of 100)
- Powder free disposable nitrile gloves
- Durable single use protective glove packed in a controlled pop up box
- Protects against contamination from dirt & potential irritants in low risk situations
- Textured surface for easy grip
- Rolled cuff for additional strength & prevention of liquid roll back

Black Premium Nitrile



- ❶ **HY271S:** Small (Pack of 100)
- ❶ **HY271M:** Medium (Pack of 100)
- ❶ **HY271L:** Large (Pack of 100)
- ❶ **HY271XL:** X-Large (Pack of 100)
- High specification, powder free disposable nitrile gloves
- **Extra** durable single use protective glove packed in a controlled pop up box
- Protects against contamination from dirt & potential irritants in low risk situations
- Textured surface for easy grip
- Rolled cuff for additional strength & prevention of liquid roll back

Green Envoy Ultimate



- ❶ **HY310M:** Medium (Pack of 50)
- ❶ **HY310L:** Large (Pack of 50)
- ❶ **HY310XL:** X-Large (Pack of 50)
- Offers protection against contamination, dirt & potential low risk situations
- **Ultra** durable & multi use protective glove packed in a controlled pop up box
- Rolled cuff for additional strength and prevention of liquid roll back
- Diamond grip surface for easy grip

Nitrile Coated Knitted



- ❶ **HY280M:** Medium (1 Pair)
- ❶ **HY280L:** Large (1 Pair)
- ❶ **HY280XL:** X-Large (1 Pair)
- Reusable, lightweight PU work glove
- Ideal for light duty protection
- Retains a sensitive feel for dexterity
- Breathable outer layer for comfort
- Perfect for mechanics, plumbers, decorators, gardening & general use





Cleaning & Safety

Interior Protection



Disposable Seat Covers



- ❶ **DPP01:** Roll of 100
- ❶ **CR09:** Roll of 500
- ❶ **DPP101:** Roll of 100 In Dispenser Box
- ❶ **DPP02:** Roll of 100 Premium



Disposable Floor Mats



- ❶ **EFME:** Brown Kraft Paper Floor Mats (Pack of 250)

5 In 1 Clean Set



- ❶ **DPP110** (100 Sets)
- Contains: 1 Seat Cover - 1 Floor Mat
- 1 Steering Wheel Cover - 1 Gear Shift Cover
- 1 Hand Brake Cover

Disposable Floor Mats



- ❶ **DPP601:** White Crepe Paper Floor Mats (Pack of 250)

Seat Cover Dispenser Bars



- ❶ **CR65:** 3 Bar Seat Cover Dispenser (1 Kit)
- ❶ **CR70:** 1 Bar Seat Cover Dispenser (1 Kit)
- One or three bar seat cover dispensers
- Wall mountable

Disposable Steering Wheel Covers



NEW

- ❶ **DPP300** (Pack of 250)



Twin Ply Disposable Blue Paper Rolls



- ❶ **HY400** (Pack of 6)
- General purpose paper wipes for use around the workshop

Premium Twin Ply Blue Paper Roll



- ❶ **HY400P** (Pack of 6)
- General purpose paper wipes for use around the workshop
- Extra absorbent
- Extra long

Centre Pull Dispenser



- ❶ **HY40D**
- Suitable for HY400 & HY400P

Twin Ply Combi Large Blue Paper Rolls Forecourt Stand



- ❶ **HY4000**: Blue Paper Rolls (Pack of 2)
- ❶ **HY4001**: Forecourt Stand
- General purpose paper wipes for use around the workshop
- 400m roll
- 1000 sheets per roll
- 400mm x 280mm sheets

Twin Ply Standard Toilet Rolls



- ❶ **HY42T** (Pack of 36)
- Twin ply toilet rolls
- 200 sheets per roll
- 115mm x 95mm sheets

Twin Ply Jumbo Toilet Rolls



- ❶ **HY39** (Pack of 6)
- ❶ **HY39D**: Dispenser
- Twin ply jumbo toilet rolls
- 1900 sheets per roll
- 200mm x 95mm sheets





Cleaning & Safety

Disposable Paper & Wipes



AutoClean Multi Purpose Wipes



- **HY2004** (Pack of 100)
- Autogem AutoClean Wipes allow you to clean your hands and surfaces of oil, grease, ground in dirt, paints and tars where no water is available, with unrivalled efficiency
- The unique formula is tough enough to remove stubborn grime though mild enough to be completely skin safe
- Ideal for the precision cleaning and maintenance of engine bay and components
- Effortlessly removes insect remains, sap and other stubborn debris from vehicle bodywork
- Removes Oil, Grease, Dirt & Grime
- Fast Acting & Ready To Use
- Ultra Tough, Non-Tear Material
- Powerful, Hand Safe Formula
- Resealable Packet



Universal Cleaning & Sanitising Wipes



- **HY2005** (Pack of 100)
- Protex are high performance disinfectant cleaner wipes with outstanding microbicidal performance including virucidal, sporicidal and mycobactericidal activity
- Conforms to:
 - BACTERICIDAL | EN 13727 EN 13697
 - YEASTICIDAL | EN 13624 EN 13697
 - MYCOBACTERICIDAL | EN 14348
 - FUNGICIDAL | EN 13624 EN 13697
 - VIRUCIDAL | EN 14476
 - SPORICIDAL | EN 13704



Fibre Cloths



- **HY41T** (Pack of 50)
- Ideal for cleaning around the workshop and in canteen areas
- Lint free

'C' Fold Paper Towels



- **HY2010** (Pack of 20 Sleeves)
- General use paper hand towels
- 176 towels per sleeve
- 310mm x 230mm sheets

Paper Towel Dispenser



- **HY2009**
- Wall mounted dispenser for HY2010



Orange Pumice Hand Cleaners



HY01



HY01D



HY07



HY07D



HY09



HY09D

- ① **HY01** (1 x 10L)
- ① **HY01D**: Hand Pump for HY01
- ① **HY07** (1 x 5L)
- ① **HY07D**: Hand Pump for HY07
- ① **HY09** (1 x 4L)
- ① **HY09D**: Dispenser for HY09
 - Environmentally friendly – contains no plastic beads
 - Superior cleaning qualities
 - Dispenser available to avoid cross contamination
 - Premium quality push button wall mounted dispenser
 - Designed to deliver measured shots to ensure only the required amount of product is dispensed for maximum cost efficiency
 - Supplied with screws & plugs for mounting

Liquid Hand Soap & Dispenser



- ① **HY19** (1 x 5L)
 - Liquid hand soap
 - Mild formula
 - Ideal for customer washroom facilities
- ① **HY19D**
 - Dispenser for HY19
 - Wall mounted
 - Pump action

Barrier Cream



- ① **HY04** (2 x 1L)
 - Provides an effective barrier against dermatitis & skin irritations
 - Protects against major soiling from oils, greases, liquids, powders & dusts

Solvent Free Hand Cleaner



- ① **HY05** (1 x 5L)
 - Mildly abrasive hand cleaner
 - Specially formulated to remove the majority of industrial contaminants
 - Solvent free option is pH balanced with a lemon fragrance





Cleaning & Safety

Cleaning



Bleach & Disinfectant



- ① HY2000: Thick Bleach (1 x 750ml)
- ① HY 2001: Thick Bleach (1 x 5L)
- ① HY13-5: Power Disinfectant With Bleach (1 x 5L)
- For regular sanitising & cleaning of toilet bowls, floors, drains, mopping equipment and other hard surfaces



All Purpose Cleaner



- ① HY2007L: Multipurpose Cleaner In Spray Bottle (1 x 750ml)
- ① HY10: All Purpose Cleaner (1 x 5L)
- For all heavy duty cleaning of hard surfaces
- Removes grease & oil



Dustbin Liners



- ① HY44 (Pack of 25)

Washing Up Liquid



- ① HY17: Washing Up Liquid (1 x 500ml)
- ① HY17-5: Washing Up Liquid With Pump (1 x 5L)
- Industrial strength double concentrated washing up liquid

Air Freshener



- ① HY15L: Honeysuckle Air Freshener (1 x 750ml)
- Fresh, clean floral scent for removing stale odours

Window Cleaner



- ① HY16L (750ml)
- For glass, ceramic tiles & other hard surfaces
- Removes finger marks & oil



Multi-Purpose Spray With Bactericide



1 HY126 (750ml)

- A liquid cleaner with a powerful bactericide for use in one stage cleaning and sanitizing
- Contains no perfumes so is non-tainting
- May be used to clean and disinfect all hard surfaces
- Tested under BSEN1276 and found to kill 99.99% of germs within 30 seconds
- Effective against *Pseudomonas aeruginosa*, *Staphylococcus aureus*, *Enterococcus hirae* and *Escherichia Coli*

Organic Spill Absorbent



1 HY102

- Fire retardant organic compound
- Suitable for workshop and industrial spillages
- Efficient and fast acting
- Highly absorbent- a single bag can absorb up to 25 litres of oil
- Can be incinerated
- Lightweight & dust free
- Supplied in practical 28 litre bags

Hard Surface Cleaner



1 HY132 (750ml)

- Contains 70% Alcohol
- Fast evaporation & Non-Corrosive
- Non-Toxic & Leaves no residue
- Contains no added fragrance

Traffic Film Remover



1 VAL195 (1 x 5L)

- Dilute with water to make up to 25 litres of traffic film remover

Screenwash



1 PG500 (1 x 5L)

- Concentrated high power; all seasons
- windscreen washer additive
- Quickly removes dirt, grime and insect deposits
- Helps prevent windscreen bottle from freezing





Cleaning & Safety

First Aid Kits



Wall Mountable First Aid Kit (Standard)



HY30

- Triangular Bandage & Fasteners x1
- Conforming Bandage (50mm) x1
- Medium Dressing (120mm x 120mm) x1
- Low Adherent Dressings (50mm x 50mm) x2
- Fabric Plasters x10
- Waterproof Plasters x10
- Antiseptic Wipes x3
- Eye Bath x1
- Pair of Latex Gloves x1
- Surgical Tape x1
- Safety Pins x6
- Finger Gauze & Applicator x1
- Forceps x1

Emergency Eyewash



HY33: Eye Wash Station (With 2 x 500ml Eye Wash Solution) (1 Kit)

HY34: Replacement Eye Wash Solution (500ml) (1 x 500ml)

- If mains tap water is not readily available for eye irrigation, at least one litre of sterile water or sterile normal saline (0.9% w/v) in sealed, disposable containers should be provided
- Once the seal has been broken, containers should not be kept for reuse
- Containers should not be used beyond their expiry date
- Source - www.hse.gov.uk

Wall Mountable First Aid Kit (1-10 Employees)



HY31

- Triangular Bandage & Fasteners x4
- Medium Dressings (120mm x 120mm) x6
- Large Dressings (180mm x 180mm) x2
- No. 16 Eye Dressings x2
- Waterproof Plasters x20
- Alcohol Free Wipes x10
- Pair of Latex Gloves x1
- HSE compliant for the work place (1-10 employees)

Wall Mounted Burns Kit



NEW

HY37

- 1 x Box 6 Ass Adhesive Wound Dressings
- 2 x Bandage Conforming 5cm x 3m (F/W)
- 1 x Bracket M3 Scan (2001BR)
- 1 x Gloves 1 Pair Vinyl
- 1 x Guidance Leaflet
- 2 x Hydrogel Burns Pad 10cm x 10cm
- 3 x Hydrogel Burns Single Sachets 6ml
- 1x Hydrogel Burns Digit Bandage 2.5cm x 50cm
- 1 x Microporous Tape (Bulk) 2.5cm x 10mt
- 1x Non Adherent Dressing 10cm x 10cm (Single)
- 3 x Non Adherent Dressing 5cm x 5cm (Single)
- 1x Non Adherent Dressing 7.5cm x 7.5cm (Single)
- 1 x Supersnip Scissors 4.5 inch S/S



EV Tools & Equipment

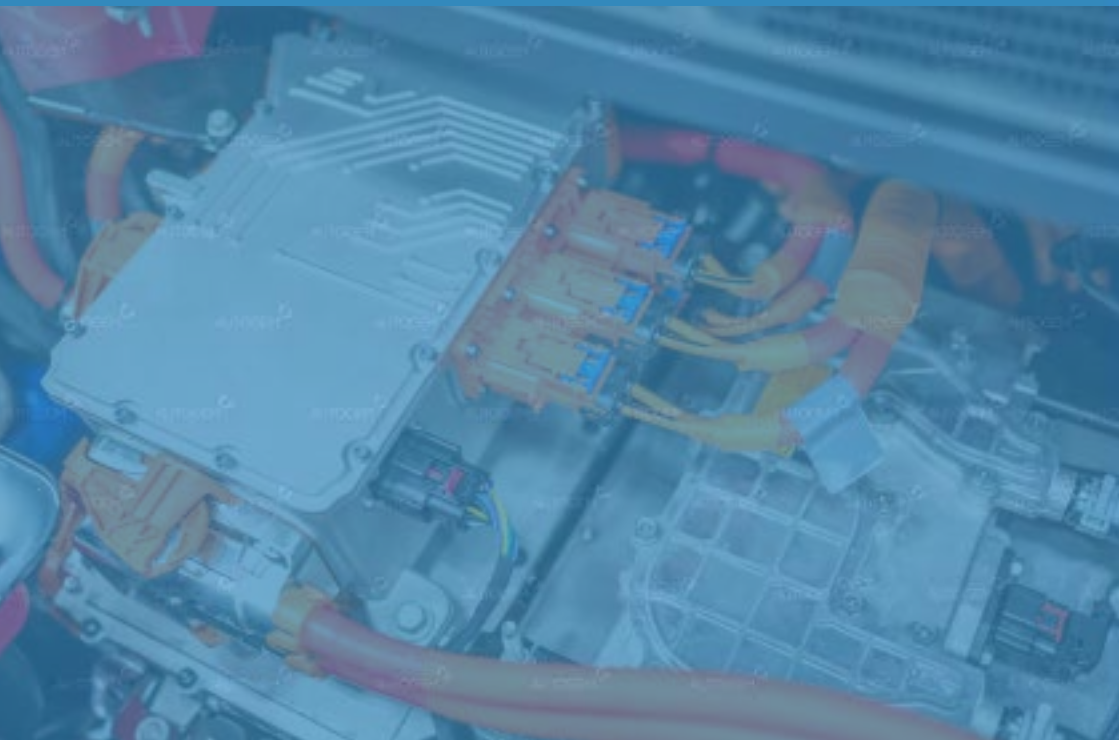



EV Tools & Equipment

Tools & Safety Wear



EHV Multimeter CAT III



NEW

EV008

- The EV008 is a true RMS Multimeter that complies with EN61010 CAT III & CAT IV making it safe for work up to 1,000 VDC
- Low pass filter for accurate measurement of VFD signals

EHV Warning Signs



EV001

- The EHV Warning Signs for Barrier Chain is supplied in a pack of 3 lightweight but durable polymer panel signs, with mounting hooks for deployment on plastic barrier chain
- Size 300 x 200mm

EHV Roof Top Warning Sign



NEW

EV014

- High visibility warning to all employees of Electric or Hybrid vehicles being present in the workshop
- Size: 310mm x 235mm x 3 sides

1000V Insulated Tool Kit 27pc VDE Approved



EV006

- One of a comprehensive range of Premier Hand Tools, suitable for daily professional use
- Each tool is fully insulated to VDE and EN 60900 standards to protect from electric shocks up to 1500V DC and 1000V AC
- Ideal for technicians working on modern hybrid and electrical vehicles (1500V DC safe live working)

Digital Infrared Laser Thermometer



EV007

- Range -50° to +650°C (-58° to +1202°F), selectable from Fahrenheit to centigrade.
- Includes back-light, hold and MIN/MAX data recording
- CE, UKCA & RoHS compliant
- Distance to spot 12:1. 1 x 9V battery included
- Auto power off with automatic data hold and laser target pointer



Electrician's Safety Gloves 1kV Pair



EV011

- Available in Medium, Large, Extra Large, and XXL
- High voltage electrician's gloves suitable for use on hybrid and electric vehicles
- Grade 0 gloves suitable for working on systems up to 1kV AC in accordance with EN 60903

High Voltage Rescue Pole



EV012

- High voltage rescue pole suitable for use up to 45kV AC in dry conditions, in accordance with EN 50508
- Supplied with wall mounting brackets and instructions for use
- Suitable for hybrid and electric vehicle applications

Red/White Post & Chain Kit 25m



EV004

- Highly visible post and chain kit ideal for creating a temporary safety barrier when working on hybrid and electric vehicles
- Consists of six red/white posts, six bases, 25m x 6mm red/white plastic chain and chain securing hooks
- Post base can be filled with dry sand for extra stability

Face Shield Visor Electric Arc Protection Lightweight



EV010

- A lightweight design with flip front protector, 1.5mm thickness protects against short circuit electric arcs
- The flip-front shield has a lightweight design with anti-fog acetate coating
- Adjustable headband gives a comfortable and secure fit
- Conforms to: EN 166 B 3.9

Electrician's Insulating Rubber Safety Mat 1 x 1m



EV009

- Class 2 High voltage insulating rubber floor mat
- Essential item required to protect vehicle technicians from the risk of electric shock when working on electric or hybrid vehicles
- Independently tested and certified as offering safe protection up to 17kV AC in accordance with BS EN 61111



Commercial Vehicles

Checkpoint®.....	109
Air Line Fittings & 24V Bulbs.....	110
Lighting & Electrical.....	111
CV TPMS.....	113



NEW

- Checkpoint Original® provides a clear indication of nut movement
- It was the first ever product of its kind in the global market to provide an indication of wheel nut movement on vehicles
- Checkpoint Original® shows a commitment to health & safety & fleet safety standards allowing an easy, walk around daily inspection for fleet managers, health & safety inspectors & drivers
- Its application has since been introduced to different sectors in order to provide a solution to loosened nuts on plant structures, rail tracks etc

- Primary functions:
- Indicate nut loosening
- Indicate nut overheating

- Primary benefits:
- Improved safety of nut fittings
- Facilitates quick & easy visual checks / audits
- Cost effective solution reducing maintenance costs & saving time

- Material:
- High grade Polymer
- Available in Fluoro Yellow or Red

- Melting Temperature:
- 125°C / 257°F

Description	Part No.	Pack
Checkpoint Indicator 27mm Yellow	CPINDY27	100
Checkpoint Indicator 27mm Yellow Large	CPINDY27L	100
Checkpoint Indicator 30mm Yellow	CPINDY30	100
Checkpoint Indicator 32mm Yellow	CPINDY32	100
Checkpoint Indicator 33mm Yellow	CPINDY33	100

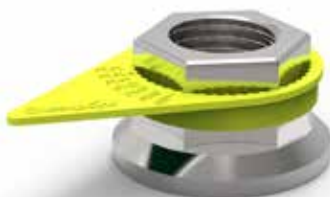



Commercial Vehicles

Air Line Fittings & 24V Bulbs



Commercial Air Line Fittings

- Where greater flow rate is required, the large diameter of these couplings makes them particularly suitable for general industrial applications
- Steel shoulder prevents accidental disconnection
- Secure locking device
- Specially designed valves provide maximum air flow
- Free flow air rate at 7 bar (100lb/in²) of:
100 to 120ft³/min - 170 to 204m³/hr - 2832 to 3398 litres/min



Description	Part No.	Pack
100 Series Female Coupling	AL39	1
100 Series Male Coupling	AL46	1
100 Series Male Adaptor	AL48	1



AL39



AL46



AL48



24V Bulbs

3W W2.1X9.5D Bulbs



CVN505 (Pack of 10)

P21W 241 Bulbs



CVN241 (Pack of 10)

R5W 149 Bulbs



CVN149 (Pack of 10)

Halogen Headlight Bulbs (H7)



CVN499A (Pack of 10)

PY21W 588 Bulbs



CV7510TSP (Pack of 10)

W5W 507 Bulbs



CVN507 (Pack of 10)





R65/R10 4-bolt 4FT Light Bar - 12V/24V



CV0-443-42

- 4ft (1200mm) Amber LED light bar with 152 SMD LEDs
- Max power 76W
- 10 Flash patterns including (double)
- ECE R65 approved
- Waterproof to IP67
- Bolt mounted with adjustable feet
- L 1200 x W 326 x H 81mm (with bracket)
- E-marked, ECE R65 & R10

140mm LED Stop/Tail & DI Rear Lamp - 12/24V



CV0-097-50

- 140mm rear stop tail and direction indicator lamp
- Protected to IP67
- Flying leads 200mm
- ABS housing PMMA lens
- E Marked R10 EMC approved

Three Bolt Multifunction Green LED Beacon - 12/24V



CV4-445-08

- Multifunction three bolt fixing beacon with green polycarbonate lens
- 9W Max
- 40 LEDs
- Double, six & rotating flash
- Current draw 0.75A @ 12VDC
- H 155mm x W 140mm
- ECE EMC R10 and CE Approved
- Protected to IP55

Amber LED Side Marker Lamp - 24V



CV0-168-60

- 24 volt LED amber side marker lamp, with reflex reflector and 'Superseal' plug, requires connector 0-011-62. 1100 x w 21 x h 50mm
- EEC and ECE approved





Commercial Vehicles

Lighting & Electrical



R10 High Intensity 2 x 6 Amber LED Warning Light



CV0-441-74

- Amber 12 x 0.5W LED ultra-high intensity LED warning light
- 12/24V
- 19 Programmable flash sequences
- L 114 x W 43.4 x H 12.5mm
- Protected to IP67
- CE, EMC R10 approved



R10 R65 High Intensity 4 Amber LED Warning Light



CV0-441-64

- 12W Power
- 4 Amber LEDs
- 12 Flash patterns
- Protected to IP69K
- Surface mount
- L 99 x W 31 x H 14mm E-Marked R10 EMC & R65 approved



2000W 24V DC to 230V AC Compact Modified Wave Voltage Inverter



CV0-856-76

- Durite 2000W 230 Volts AC modified wave inverter uses Surface
- Mount Technology (SMT).
- Input 22-30V DC to 230V AC 50Hz output
- 2000W continuous power output
- Fan cooling
- Fast charging 2.1A output
- 2 x standard 3-pin BS1363 UK socket outlet
- ON/OFF/Remote switch E-marked, EMC, R10 approved



Black Nylon Heavy-Duty Convuluted Unsplit Tubing 17NW x 50m



CV0-330-17

- Black nylon heavy duty convuluted un-split tubing.
- Sealed to protect cables and looms against external elements.





Are You CV TPMS Ready?

Since July 2022 trucks and buses have begun adopting TPMS sensors to fall in line with new legislation. From July 2024 **ALL** commercial vehicles are mandated to include a tyre pressure warning system as standard.

i-sensor® Pro HD is here...

Contactless sensor diagnosis & easy, on demand sensor replacement from our **programmable**, universal, high pressure sensors.

Works with **OE & aftermarket systems**, including Continental, Goodyear, Michelin & Wabco.

Combining the unrivalled i-sensor® pro chassis with our TPMS expertise you can't go wrong!



Same Chassis with CV Software



Wide Coverage of OE & Aftermarket



Multi Wheel, Multi Axle Configurator



Multi & Single Sensor Diagnosis



OBDII Interoperability with Onboard Relearns



Universal High Pressure Sensor & Strap System



Long Life Battery & Status Reporting to 1%



Tyre Management Data



Intuitive Data Capture Tools

CV TPMS Valve Stems

Currently, there are 3 main styles of OE sensor and these can all be serviced using any of the 5 common valve stems shown below.



**TPKCV01
40mm**



**TPKCV02
52mm**



**TPKCV03
57mm 45° Bend**



**TPKCV04
70mm 7° Bend**



**TPKCV05
78mm 7° Bend**



Emission Control

Since the 1960's, Autogem has had a long history of developing and manufacturing exhaust fittings.



Emission Gaskets

Our formidable reputation is founded upon the most complete range of exhaust, catalytic converter and DPF gaskets available. Manufactured in a wide variety of materials and heat specifications we provide the total solution for emissions gaskets, be they at the manifold or at the end pipe. Many of the parts we make are bespoke for manufacturer customers and please do not hesitate to enquire about any specific gasket requirements that you may have.

Clamps

Still the most important category for exhaust fittings is clamps. We offer muffler clamps in 3/8", 5/16", M8 and M10 variations. All clamps can be supplied in mild steel or stainless steel. Our clamp offering also includes pipe connector clamps, circular clamps and various manufacturer specific OE style clamps. Clamps can also be supplied with standard, copper or thick nuts as per your requirements. In addition to our standard automotive and truck clamps, we also manufacture bespoke clamps for the industrial, agricultural and defence markets.



Hangers & Mountings

Now offering a supplemental range of EPDM and SBR hangers alongside our traditional rubber compounds we offer a wide variety of rubber and rubber to metal bonded bracketing solutions. In addition to this we have also introduced lighter aluminium to rubber bonded brackets as per the OE specification. Our full line coverage allows us to straddle both the North American and European markets in this sector.



Brackets & Kits

Kits have become one of the fastest growing categories in our range and we offer comprehensive solutions for both exhaust and catalytic converter kits. Many of these kits require premium quality gaskets in conjunction with the bolts, springs and nuts and this allows us to offer a fully comprehensive solution to your requirements. Our brackets go through vigorous welding processes and testing, ensuring the brackets you supply for the underside of the vehicle are 100% dependable.

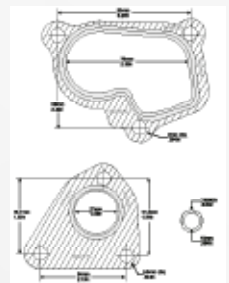

shop.autogem.co.uk



Take advantage of our online ordering platform which really does offer consumables at your convenience. With a trade login you can view your prices, build orders & submit them when you're ready. *Scan the QR* to learn more about the Autogem online shop.



Browse Full Range



Intuitive Search Function



Select From Alternatives



View COSHH Data Sheets



Build, View & Save Basket



Favourite Items & Wishlists



Submit When Ready



Review & Reorder



Spend Controls Upon Request





Our Contacts

Telesales / Ordering:	+44(0)20 8838 0910 + Opt 1
Email:	sales@autogem.co.uk
Online Shop:	www.shop.autogem.co.uk
Customer Services:	+44(0)20 8838 0910 + Opt 2
Accounts:	+44(0)20 8838 0910 + Opt 3
TPMS & Technical Support:	+44(0)20 8838 0910 + Opt 4
TPMS Zone:	www.autogem.co.uk/tpms

www.autogem.co.uk



Autogem Shop



TPMS Assistant



TPMS Zone

Your Sales Representative